

Diode Laser Hair Removal Machine



User Manual

Content

Chapter One - Introduction	3
I. Theory.....	3
II. Application	3
III. Contraindications	3
IV. Features	4
V. Product Specifications	4
Chapter Two - Safety Regulations	5
I. Safety introduction.....	5
II. Electrical and mechanical safety	5
Chapter Three - Installation	6
II. Accessories.....	7
III.....	8
IV. Installation	8
Chapter Four - Operation Instruction	13
II.....	13
III. Treatment Interface	13
Touch it, you will back to the main interface.....	14
Chapter Five - Clinical Application	15
I. Treatment procedure	15
II. Treatment parameter	16
Chapter Six Simple Maintenance and Repair	44
I. Normal problems and failures.....	44
II. Daily maintenance and repair	44
III. Warranty.....	47

Chapter One - Introduction

I. Theory

During a laser hair removal treatment, light passes through the skin and is absorbed by the melanin in the hair shaft. This absorption raises the temperature of the hair follicle and thermally destroys the cells responsible for regrowth without negatively affecting the surrounding skin tissue.

II. Application

Suitable for fast, safe, painless and permanent hair removal on all 6 skin types in any area including face, arms, armpits, chest, back, bikini, and legs.

III. Contraindications

1. Cancer, especially skin cancer
2. Pregnancy
3. Current use photosensitive drugs and medicine
4. Known irritation from 808 nm wavelength light source
5. Artificial sun exposure from tanning bed for up to 3-4 weeks prior to treatment
6. Active herpes simplex infections
7. Hair growth on Scars
8. Diabetes as (rely on insulin injections)
 - They will feel more pain due to sensitive nerves & tissue.
 - They will be easier to burn and blister due to damage nerve endings.
 - They are more susceptible to infections due to the slower healing response.
 - The hair removal is less effective since lower blood flow to the surface of the skin may require lower settings on the laser.
9. Dry and sensitive skin
10. Endocrine disorders (light will produce stimulation)
11. Use of anti-clotting agent
12. Epilepsy
13. A history of blood clotting

IV. Features

1. The 808nm diode laser hair removal system uses the most advanced technology in laser hair removal that penetrates better, has better performance and clinical results, safely.
2. High energy: excellent treatment result can be expected at the first treatment for all types of hair.
3. Long laser width: Effective for the hair follicles produce heat accumulation, Permanent hair removal.
4. Safety: Will not burn or scar skin
5. The powerful Sapphire touch cooling system cools the skin so the whole process is painless.
6. Quick: This new technology is 5 times faster than the original hair removal lasers.
7. The best thermostatic water cycle system guarantees semiconductor pump won't overheat.

V. Product Specifications

Model	Soprano ice laser
Display system	15 inch Color microcomputer touch screen
Laser Type	High power 3 waves Diode laser
Wavelength	755nm+808nm+1064nm
Frequency	1-10hz
Pulse Duration	5~300ms adjustable
Energy	1-320J adjustable
Treatment area size	12*35mm ²
Cooling system	Sapphire cooling style+air+semi-conductor+smart TEC
Crystal temperature	-10~5° C
Power requirement	AC 110V/220 50~60Hz

Chapter Two - Safety Regulations

I. Safety introduction

This diode laser System is a safe and reliable high-tech device. Trained and qualified personnel can use this machine safely following proper operational and maintenance procedures. Operators should fully understand the safety information in this chapter. Built in safety precautions:

- 1) The Automatic Inspection system is initiated after turning on the machine, and continuously monitors the electric circuits during operation.
- 2) This device has ground fault safety circuits, power will be shut off automatically in case of electric short.
- 3) The red emergency button can be used to cut off the power supply immediately if an emergency happens.
- 4) Switch keys can prevent others from turning on the machine without permission.

II. Electrical and mechanical safety

- a. Do not open the case of the machine, residual shock can happen even when unplugged.
- b. Only authorized service professionals should work on the machine.
- c. During maintenance, please unplug the power, do not open the cover of the machine.
- d. The device can be moved slowly with care.
- e. The machine must be plugged in using standard three-wire power cords with grounding for safe operation.

【PREVENT FIRE】

- a. Do not use ethanol, acetone or other flammable things on skin before treatment. If necessary, please use soap and water.
- b. After sanitizing the treatment head or other parts with ethanol, please allow to dry prior to operation.

【AUTOMATIC INSPECTION】

After turning on the machine, the system will do an automatic inspection on electric circuit. About 1-3 minutes later it will begin running automatically, then it enters into treatment interface.

Chapter Three - Installation

I. Shipping Box

The machine is package as in the shipping case pictured below. If any damage happened during transportation, please contact us or carrier immediately!



How to open the box?



Picture One

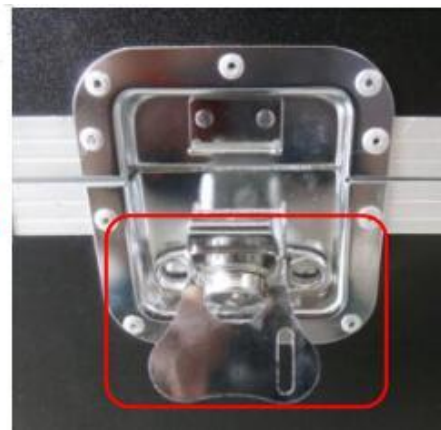

Picture Two

- Lift up the spanner and turn it right as in picture 1 above to the position shown in Picture 2.
- Flip the lever, then the box can be opened.

II. Accessories

NO.	Name	QTY.	Picture
1	Laser Hand Piece	2 PC	
2	Water Filter	4+2 PCS	
3	Power cord	1 PC	
4	U disk	1 PC	
5	Start-up key	2 PC	
6	Goggle	1 PC	
7	Protective glasses	1 PC	
8	Funnel	1 Set	
9	Screws	6 PC	
10	Foot pedal	1 PC	

Notice: Please confirm that the accessories are in your package, if any accessories were lost in

transportation, please contact us immediately.

III. Main Machine

- ① 15 TFT Color Touch Screen
- ② Emergency Button
- ③ On/OFF Keys
- ④ Laser Hand connector
- ⑤ Laser Hand Piece
- ⑥ Laser Hand Piece Holder

Side view



- ① The radiator fan Air Switch
- ② TEC cooling system
- ③ The power cord jack
- ④ Water inlet
- ⑤ Water window
- ⑥ Water outlet

Back View



IV. Installation

Installation of this device should be performed by a professional technical person who has been

trained by the equipment manufacturer.

CAUTION

Assure that the machine is installed on a level surface Install the product on a level area

Water Source: Please use only pure water or distilled water
(CAUTION: please change water each month.

Notice:

Please read this carefully before operating the machine.

Please plug in the hand piece tightly, otherwise, the water hose may break and cause a short circuit.

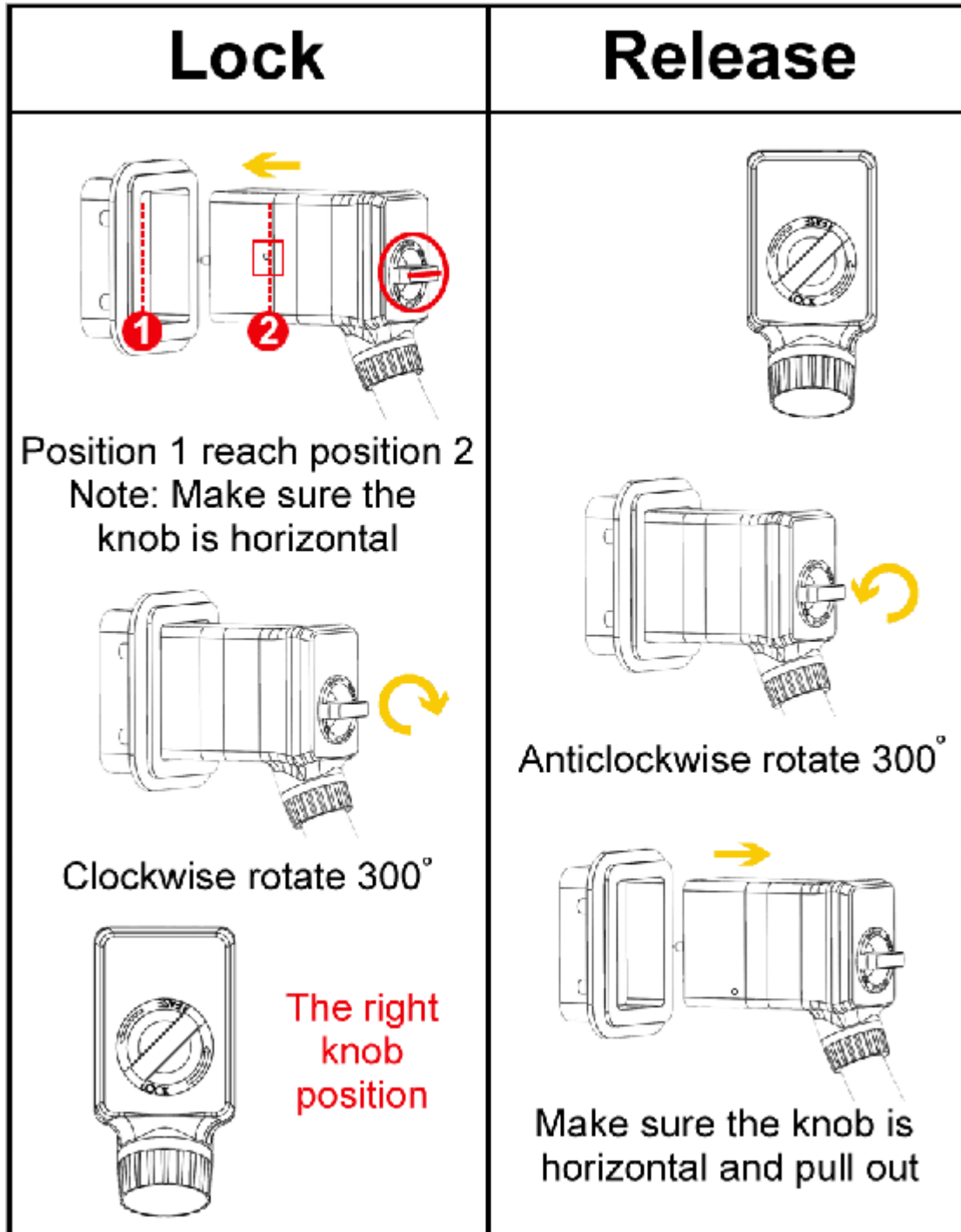

Warning: Must insert the handpiece or remove the handpiece according to follow steps to avoid breaking the connector .

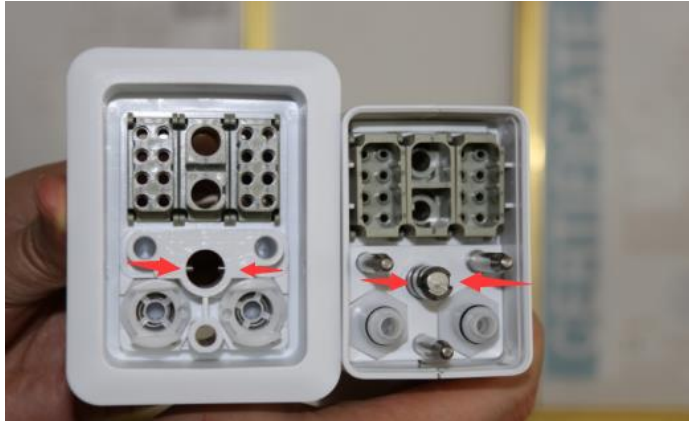

Please check the structure of inside of handpiece connector , those parts should be connected correctly .

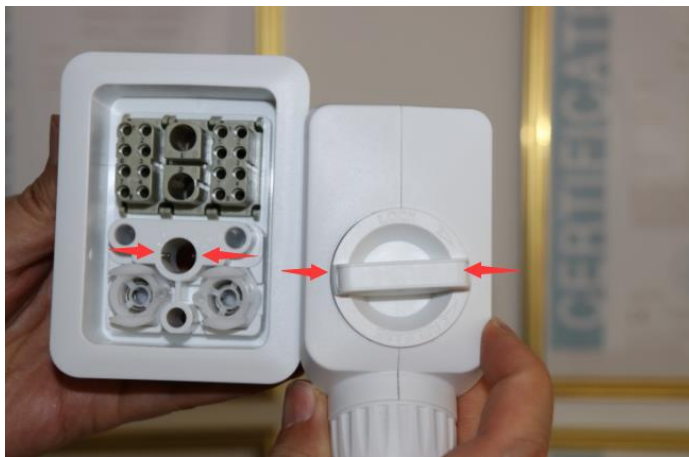

So the button of connector should in a parallel position when you are going to insert the handpiece .



Then turn the button with clockwise direction until it is stable as the button position in above picture



When you want to remove the handpiece , turn the button according to anticlockwise direction . Finally you can pull it out smoothly .

When you add water or operate the machine, please make sure the exhaust vent is open.



When you receive the new machine, please add water and operate it for 5 minutes, then change the water. In future, please change the PP cotton filter every 6 months and resin filter ever year. Change the water in the machine monthly.

Make sure you use distilled water or deionized water. After each fill turn on the machine and recheck the water level.

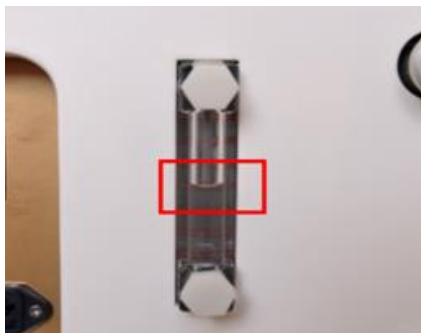

Please wait for at least one minute before you turn on the machine again, because the power supply has continuous restart protection.

Chapter Four - Operation Instruction

II. Main Interface







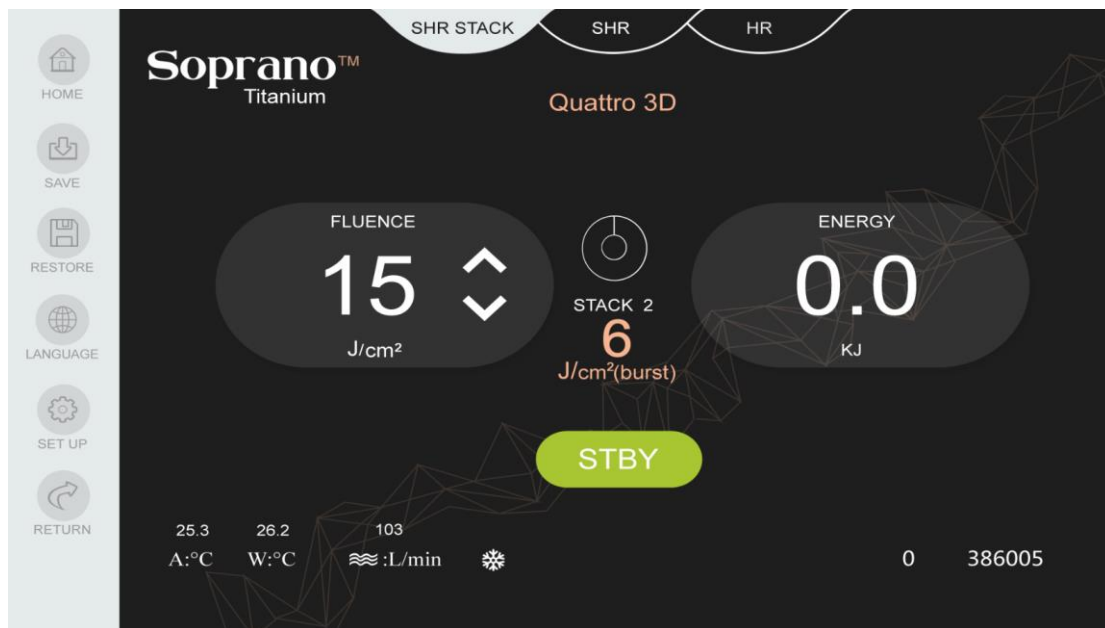

Touch logo on welcome interface, go to below interface

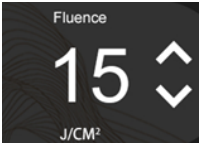

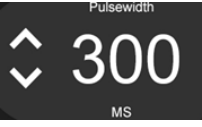
Touch the spot size of the handle, will go to the treatment interface.

III. Treatment Interface

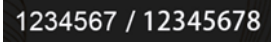

	<p>Energy density, touch , then you can increase the energy, touch  you can decrease the energy.</p>
	<p>MS measures the pulse width, the minimum pulse width is 0 ,the maximum pulse width is 400. The pulse width is the laser light working time on the skin. If you set 100ms, then the light will work on skin 100ms.</p>
	<p>The frequency is 1-10, adjustable. It means how many flashes by one shot.</p>
	<p>Touch it, you will back to the main interface</p>
	<p>This button is used to save the parameters which you have set in the software.</p>
	<p>Touch it, the treatment parameter will be our factory set one.</p>
	<p>This is ready button. Press this Ready button, it will become </p>
	<p>This is the shots record for all shots and one treatment shots.</p>

Chapter Five - Clinical Application

Preparation

Keep ignitable and explosive liquid and gas, including alcohol, nitrous oxide and oxygen, away from the radiation of the light.

Ornaments that reflect light, such as Jewelry, should always be taken off by the patient and operator.

1. The patient should be provided with adequate protection for the eyes, such as protective eyewear.
2. Always place the hand piece back in its cradle after use.
3. It is recommended that a warning sign be placed at the entrance to the treatment room whenever the system is in use.
4. Initial treatments should be use the lowest energy setting to ascertain the reaction to the skin using the Fitzpatrick Scale as a guide.

I. Treatment procedure

Preparation Instructions

In order to provide you with the best possible service we ask that you carefully Review these Pre- and Post-Treatment instructions.

1. Please follow all guidelines in the Laser Hair Removal consent form. Discuss your medical history (medications, allergies, Fitzpatrick skin typing and any tendency for scarring or poor healing) with your laser technician.
2. Do not use any medications that cause photosensitivity for at least 6 weeks prior to laser treatments. If you are taking a prescription medication that causes photosensitivity, please contact your prescribing physician to discuss your options.
3. Avoid sun tanning or sunless tanning products for as long as possible before laser treatments (4 to 6 weeks is recommended).
4. Avoid depilatory (hair removal) creams, plucking, waxing or electrolysis for at least 6 weeks before laser treatments.
5. Do not use Accutane (or products containing isotretinoin) for at least 6 months prior to laser treatments.
6. Do not use Retin-A (or products containing tretinoin) for at least 2 weeks prior to laser treatments.
7. The treatment area must be free of any open sores, lesions, or skin Infections.

Patient Preparation On the day of your appointment

1. Shave the area to be treated. If the hair in the treatment area is very sparse, please let us trim the area at the time of your treatment as this allows us to better define the treatment area.
2. Gently wash the area to be treated and do not apply creams, lotions or other products to the area

except a topical anesthetic (if being used).

3. If you have elected to use a topical anesthetic, do so only after reviewing all cautions associated with its use. Apply and use as directed prior to arrival.
4. Dress so that you may modestly expose the treatment area.
5. If you choose to, you may take over the counter anti-inflammatory medication such as ibuprofen before arrival.
6. Please arrive 15 minutes early for your first appointment and 10 minutes early for subsequent appointments. This will allow time for necessary paperwork and keep you on schedule, please be on time for your appointments.

II. Treatment parameter

Attention: This protocol is just a reference for different skin type. No matter which skin operates must try from lower energy to higher energy to try. Forbidden use Max energy to try for patient!!

Warning:

For the beginner user , we suggest use frequency 1-2Hz (following green table) ,

For the beautician who are familiar with this machine, you could use parameter in blue table (3-4Hz),

For the quite expert in laser operation filed , you could use the parameter in orange table with higher frequency 5-6Hz.

For the parameter in red table, we don't suggest use normally , because there is too higher power has risk to burn skin if any accident during treatment .

SHR mode treatment parameter : Meaning in motion mode .Such as You can slide the handle on the skin about 4-5 times with 3Hz in same treatment area .

Recommend you choose the SHR mode during treatment , all good feedback from our customers with SHR mode treatment parameters

755/808/1064 Diode laser treatment parameters (12*20)

Spot size (mm ²) Frequency		12*20 1HZ				
MAN	I	II	III	IV	V	VI
Face	Energy: 34 HZ: 1	Energy: 31 HZ: 1	Energy: 31 HZ: 1	Energy: 30 HZ: 1	Energy: 30 HZ: 1	Energy: 30 HZ: 1
Armpit	Energy: 35 HZ: 1	Energy: 34 HZ: 1	Energy: 34 HZ: 1	Energy: 33 HZ: 1	Energy: 33 HZ: 1	Energy: 30 HZ: 1
Hairline	Energy: 30 HZ: 1	Energy: 29 HZ: 1	Energy: 28 HZ: 1	Energy: 27 HZ: 1	Energy: 27 HZ: 1	Energy: 25 HZ: 1
Bikini	Energy: 29 HZ: 1	Energy: 28 HZ: 1	Energy: 27 HZ: 1	Energy: 27 HZ: 1	Energy: 26 HZ: 1	Energy: 26 HZ: 1
Thigh	Energy: 35 HZ: 1	Energy: 35 HZ: 1	Energy: 34 HZ: 1	Energy: 33 HZ: 1	Energy: 33 HZ: 1	Energy: 30 HZ: 1
Leg	Energy: 34 HZ: 1	Energy: 33 HZ: 1	Energy: 33 HZ: 1	Energy: 27 HZ: 1	Energy: 27 HZ: 1	Energy: 34 HZ: 1

FEMALE	I	II	III	IV	V	VI
Whiskers	Energy: 35 HZ: 1	Energy: 34 HZ: 1	Energy: 31 HZ: 1	Energy: 27 HZ: 1	Energy: 25 HZ: 1	Energy: 25 HZ: 1
Armpit	Energy: 35 HZ: 1	Energy: 35 HZ: 1	Energy: 34 HZ: 1	Energy: 30 HZ: 1	Energy: 30 HZ: 1	Energy: 30 HZ: 1
Hairline	Energy: 27 HZ: 1	Energy: 26 HZ: 1	Energy: 26 HZ: 1	Energy: 25 HZ: 1	Energy: 25 HZ: 1	Energy: 25 HZ: 1
Bikini	Energy: 30 HZ: 1	Energy: 29 HZ: 1	Energy: 28 HZ: 1	Energy: 26 HZ: 1	Energy: 25 HZ: 1	Energy: 25 HZ: 1
Thigh	Energy: 35 HZ: 1	Energy: 34 HZ: 1	Energy: 33 HZ: 1	Energy: 28 HZ: 1	Energy: 27 HZ: 1	Energy: 26 HZ: 1
Leg	Energy: 34 HZ: 1	Energy: 33 HZ: 1	Energy: 31 HZ: 1	Energy: 30 HZ: 1	Energy: 27 HZ: 1	Energy: 27 HZ: 1

Spot size (mm²) 12*20
Frequency 2HZ

MAN	I	II	III	IV	V	VI
Face	Energy: 68 HZ: 2	Energy: 62 HZ: 2	Energy: 62 HZ: 2	Energy: 60 HZ: 2	Energy: 60 HZ: 2	Energy: 60 HZ: 2
Armpit	Energy: 70 HZ: 2	Energy: 68 HZ: 2	Energy: 68 HZ: 2	Energy: 66 HZ: 2	Energy: 66 HZ: 2	Energy: 60 HZ: 2
Hairline	Energy: 60 HZ: 2	Energy: 58 HZ: 2	Energy: 56 HZ: 2	Energy: 54 HZ: 2	Energy: 54 HZ: 2	Energy: 50 HZ: 2
Bikini	Energy: 58 HZ: 2	Energy: 56 HZ: 2	Energy: 54 HZ: 2	Energy: 54 HZ: 2	Energy: 52 HZ: 2	Energy: 52 HZ: 2
Thigh	Energy: 70 HZ: 2	Energy: 70 HZ: 2	Energy: 68 HZ: 2	Energy: 66 HZ: 2	Energy: 66 HZ: 2	Energy: 60 HZ: 2
Leg	Energy: 68 HZ: 2	Energy: 66 HZ: 2	Energy: 66 HZ: 2	Energy: 54 HZ: 2	Energy: 54 HZ: 2	Energy: 68 HZ: 2

FEMALE	I	II	III	IV	V	VI
Whiskers	Energy: 70 HZ: 2	Energy: 68 HZ: 2	Energy: 62 HZ: 2	Energy: 54 HZ: 2	Energy: 50 HZ: 2	Energy: 50 HZ: 2
Armpit	Energy: 70 HZ: 2	Energy: 70 HZ: 2	Energy: 68 HZ: 2	Energy: 60 HZ: 2	Energy: 60 HZ: 2	Energy: 60 HZ: 2
Hairline	Energy: 54 HZ: 2	Energy: 52 HZ: 2	Energy: 52 HZ: 2	Energy: 50 HZ: 2	Energy: 50 HZ: 2	Energy: 50 HZ: 2
Bikini	Energy: 60 HZ: 2	Energy: 58 HZ: 2	Energy: 56 HZ: 2	Energy: 52 HZ: 2	Energy: 50 HZ: 2	Energy: 50 HZ: 2
Thigh	Energy: 70 HZ: 2	Energy: 68 HZ: 2	Energy: 66 HZ: 2	Energy: 56 HZ: 2	Energy: 54 HZ: 2	Energy: 52 HZ: 2
Leg	Energy: 68 HZ: 2	Energy: 66 HZ: 2	Energy: 62 HZ: 2	Energy: 60 HZ: 2	Energy: 54 HZ: 2	Energy: 54 HZ: 2

Spot size (mm²) 12*20
Frequency 3HZ

FEMALE	I	II	III	IV	V	VI
Whiskers	Energy: 105 HZ: 3	Energy: 102 HZ: 3	Energy: 93 HZ: 3	Energy: 81 HZ: 3	Energy: 75 HZ: 3	Energy: 75 HZ: 3
Armpit	Energy: 105 HZ: 3	Energy: 105 HZ: 3	Energy: 102 HZ: 3	Energy: 90 HZ: 3	Energy: 90 HZ: 3	Energy: 90 HZ: 3
Hairline	Energy: 81 HZ: 3	Energy: 78 HZ: 3	Energy: 78 HZ: 3	Energy: 75 HZ: 3	Energy: 75 HZ: 3	Energy: 75 HZ: 3
Bikini	Energy: 90 HZ: 3	Energy: 87 HZ: 3	Energy: 84 HZ: 3	Energy: 78 HZ: 3	Energy: 75 HZ: 3	Energy: 75 HZ: 3
Thigh	Energy: 105 HZ: 3	Energy: 102 HZ: 3	Energy: 99 HZ: 3	Energy: 84 HZ: 3	Energy: 81 HZ: 3	Energy: 78 HZ: 3
Leg	Energy: 102 HZ: 3	Energy: 99 HZ: 3	Energy: 93 HZ: 3	Energy: 90 HZ: 3	Energy: 81 HZ: 3	Energy: 81 HZ: 3

MAN	I	II	III	IV	V	VI
Face	Energy: 102 HZ: 3	Energy: 93 HZ: 3	Energy: 93 HZ: 3	Energy: 90 HZ: 3	Energy: 90 HZ: 3	Energy: 90 HZ: 3
Armpit	Energy: 105 HZ: 3	Energy: 102 HZ: 3	Energy: 102 HZ: 3	Energy: 99 HZ: 3	Energy: 99 HZ: 3	Energy: 90 HZ: 3
Hairline	Energy: 90 HZ: 3	Energy: 78 HZ: 3	Energy: 84 HZ: 3	Energy: 81 HZ: 3	Energy: 81 HZ: 3	Energy: 75 HZ: 3
Bikini	Energy: 78 HZ: 3	Energy: 84 HZ: 3	Energy: 81 HZ: 3	Energy: 81 HZ: 3	Energy: 78 HZ: 3	Energy: 78 HZ: 3
Thigh	Energy: 105 HZ: 3	Energy: 105 HZ: 3	Energy: 102 HZ: 3	Energy: 99 HZ: 3	Energy: 99 HZ: 3	Energy: 90 HZ: 3
Leg	Energy: 102 HZ: 3	Energy: 99 HZ: 3	Energy: 99 HZ: 3	Energy: 81 HZ: 3	Energy: 81 HZ: 3	Energy: 102 HZ: 3

Spot size (mm²) 12*20
 Frequency 4HZ

FEMALE	I	II	III	IV	V	VI
Whiskers	Energy: 140 HZ: 4	Energy: 136 HZ: 4	Energy: 124 HZ: 4	Energy: 108 HZ: 4	Energy: 100 HZ: 4	Energy: 100 HZ: 4
Armpit	Energy: 140 HZ: 4	Energy: 140 HZ: 4	Energy: 136 HZ: 4	Energy: 120 HZ: 4	Energy: 120 HZ: 4	Energy: 120 HZ: 4
Hairline	Energy: 108 HZ: 4	Energy: 104 HZ: 4	Energy: 104 HZ: 4	Energy: 100 HZ: 4	Energy: 100 HZ: 4	Energy: 100 HZ: 4
Bikini	Energy: 120 HZ: 4	Energy: 116 HZ: 4	Energy: 112 HZ: 4	Energy: 104 HZ: 4	Energy: 100 HZ: 4	Energy: 100 HZ: 4
Thigh	Energy: 140 HZ: 4	Energy: 136 HZ: 4	Energy: 132 HZ: 4	Energy: 112 HZ: 4	Energy: 108 HZ: 4	Energy: 104 HZ: 4
Leg	Energy: 136 HZ: 4	Energy: 132 HZ: 4	Energy: 124 HZ: 4	Energy: 120 HZ: 4	Energy: 108 HZ: 4	Energy: 108 HZ: 4

MAN	I	II	III	IV	V	VI
Face	Energy: 136 HZ: 4	Energy: 124 HZ: 4	Energy: 124 HZ: 4	Energy: 120 HZ: 4	Energy: 120 HZ: 4	Energy: 120 HZ: 4
Armpit	Energy: 140 HZ: 4	Energy: 136 HZ: 4	Energy: 136 HZ: 4	Energy: 132 HZ: 4	Energy: 132 HZ: 4	Energy: 120 HZ: 4
Hairline	Energy: 120 HZ: 4	Energy: 116 HZ: 4	Energy: 112 HZ: 4	Energy: 108 HZ: 4	Energy: 108 HZ: 4	Energy: 100 HZ: 4
Bikini	Energy: 116 HZ: 4	Energy: 112 HZ: 4	Energy: 108 HZ: 4	Energy: 108 HZ: 4	Energy: 104 HZ: 4	Energy: 108 HZ: 4
Thigh	Energy: 140 HZ: 4	Energy: 140 HZ: 4	Energy: 136 HZ: 4	Energy: 132 HZ: 4	Energy: 132 HZ: 4	Energy: 120 HZ: 4
Leg	Energy: 136 HZ: 4	Energy: 132 HZ: 4	Energy: 132 HZ: 4	Energy: 108 HZ: 4	Energy: 108 HZ: 4	Energy: 136 HZ: 4

Spot size (mm²) 12*20
Frequency 5HZ

FEMALE	I	II	III	IV	V	VI
Whiskers	Energy: 175 HZ: 5	Energy: 170 HZ: 5	Energy: 155 HZ: 5	Energy: 135 HZ: 5	Energy: 125 HZ: 5	Energy: 125 HZ: 5
Armpit	Energy: 175 HZ: 5	Energy: 175 HZ: 5	Energy: 170 HZ: 5	Energy: 150 HZ: 5	Energy: 150 HZ: 5	Energy: 150 HZ: 5
Hairline	Energy: 135 HZ: 5	Energy: 130 HZ: 5	Energy: 130 HZ: 5	Energy: 125 HZ: 5	Energy: 125 HZ: 5	Energy: 125 HZ: 5
Bikini	Energy: 150 HZ: 5	Energy: 145 HZ: 5	Energy: 140 HZ: 5	Energy: 130 HZ: 5	Energy: 125 HZ: 5	Energy: 125 HZ: 5
Thigh	Energy: 175 HZ: 5	Energy: 170 HZ: 5	Energy: 165 HZ: 5	Energy: 140 HZ: 5	Energy: 135 HZ: 5	Energy: 130 HZ: 5
Leg	Energy: 170 HZ: 5	Energy: 165 HZ: 5	Energy: 155 HZ: 5	Energy: 150 HZ: 5	Energy: 135 HZ: 5	Energy: 135 HZ: 5

MAN	I	II	III	IV	V	VI
Face	Energy: 170 HZ: 5	Energy: 155 HZ: 5	Energy: 155 HZ: 5	Energy: 150 HZ: 5	Energy: 135 HZ: 5	Energy: 150 HZ: 5
Armpit	Energy: 170 HZ: 5	Energy: 170 HZ: 5	Energy: 170 HZ: 5	Energy: 165 HZ: 5	Energy: 165 HZ: 5	Energy: 150 HZ: 5
Hairline	Energy: 150 HZ: 5	Energy: 145 HZ: 5	Energy: 140 HZ: 5	Energy: 135 HZ: 5	Energy: 135 HZ: 5	Energy: 125 HZ: 5
Bikini	Energy: 145 HZ: 5	Energy: 140 HZ: 5	Energy: 135 HZ: 5	Energy: 135 HZ: 5	Energy: 130 HZ: 5	Energy: 130 HZ: 5
Thigh	Energy: 175 HZ: 5	Energy: 175 HZ: 5	Energy: 170 HZ: 5	Energy: 165 HZ: 5	Energy: 165 HZ: 5	Energy: 150 HZ: 5
Leg	Energy: 170 HZ: 5	Energy: 165 HZ: 5	Energy: 165 HZ: 5	Energy: 135 HZ: 5	Energy: 140 HZ: 5	Energy: 170 HZ: 5

Spot size (mm²) 12*20
 Frequency 6HZ

FEMALE	I	II	III	IV	V	VI
Whiskers	Energy: 210	Energy: 204	Energy: 186	Energy: 162	Energy: 150	Energy: 150
	HZ: 6	HZ: 6	HZ: 6	HZ: 6	HZ: 6	HZ: 6
Armpit	Energy: 210	Energy: 210	Energy: 204	Energy: 180	Energy: 180	Energy: 180
	HZ: 6	HZ: 6	HZ: 6	HZ: 6	HZ: 6	HZ: 6
Hairline	Energy: 162	Energy: 156	Energy: 156	Energy: 150	Energy: 150	Energy: 175
	HZ: 6	HZ: 6	HZ: 6	HZ: 6	HZ: 6	HZ: 6
Bikini	Energy: 180	Energy: 174	Energy: 168	Energy: 156	Energy: 150	Energy: 150
	HZ: 6	HZ: 6	HZ: 6	HZ: 6	HZ: 6	HZ: 6
Thigh	Energy: 210	Energy: 204	Energy: 198	Energy: 168	Energy: 162	Energy: 156
	HZ: 6	HZ: 6	HZ: 6	HZ: 6	HZ: 6	HZ: 6
Leg	Energy: 204	Energy: 198	Energy: 186	Energy: 180	Energy: 162	Energy: 162
	HZ: 6	HZ: 6	HZ: 6	HZ: 6	HZ: 6	HZ: 6

MAN	I	II	III	IV	V	VI
Face	Energy: 204	Energy: 186	Energy: 186	Energy: 180	Energy: 180	Energy: 180
	HZ: 6	HZ: 6	HZ: 6	HZ: 6	HZ: 6	HZ: 6
Armpit	Energy: 210	Energy: 204	Energy: 204	Energy: 198	Energy: 198	Energy: 180
	HZ: 6	HZ: 6	HZ: 6	HZ: 6	HZ: 6	HZ: 6
Hairline	Energy: 180	Energy: 174	Energy: 168	Energy: 162	Energy: 162	Energy: 150
	HZ: 6	HZ: 6	HZ: 6	HZ: 6	HZ: 6	HZ: 6
Bikini	Energy: 174	Energy: 168	Energy: 162	Energy: 162	Energy: 156	Energy: 156
	HZ: 6	HZ: 6	HZ: 6	HZ: 6	HZ: 6	HZ: 6
Thigh	Energy: 210	Energy: 210	Energy: 204	Energy: 198	Energy: 198	Energy: 180
	HZ: 6	HZ: 6	HZ: 6	HZ: 6	HZ: 6	HZ: 6
Leg	Energy: 204	Energy: 198	Energy: 198	Energy: 162	Energy: 162	Energy: 204
	HZ: 6	HZ: 6	HZ: 6	HZ: 6	HZ: 6	HZ: 6

Spot size (mm²) 12*20
 Frequency 7HZ

FEMALE	I	II	III	IV	V	VI
Whiskers	Energy: 245 HZ: 7	Energy: 238 HZ: 7	Energy: 217 HZ: 7	Energy: 189 HZ: 7	Energy: 175 HZ: 7	Energy: 175 HZ: 7
Armpit	Energy: 245 HZ: 7	Energy: 245 HZ: 7	Energy: 238 HZ: 7	Energy: 210 HZ: 7	Energy: 210 HZ: 7	Energy: 210 HZ: 7
Hairline	Energy: 189 HZ: 7	Energy: 182 HZ: 7	Energy: 182 HZ: 7	Energy: 175 HZ: 7	Energy: 175 HZ: 7	Energy: 175 HZ: 7
Bikini	Energy: 210 HZ: 7	Energy: 203 HZ: 7	Energy: 196 HZ: 7	Energy: 182 HZ: 7	Energy: 175 HZ: 7	Energy: 175 HZ: 7
Thigh	Energy: 245 HZ: 7	Energy: 238 HZ: 7	Energy: 231 HZ: 7	Energy: 196 HZ: 7	Energy: 189 HZ: 7	Energy: 182 HZ: 7
Leg	Energy: 238 HZ: 7	Energy: 231 HZ: 7	Energy: 217 HZ: 7	Energy: 210 HZ: 7	Energy: 189 HZ: 7	Energy: 189 HZ: 7

MAN	I	II	III	IV	V	VI
Face	Energy: 238 HZ: 7	Energy: 217 HZ: 7	Energy: 217 HZ: 7	Energy: 210 HZ: 7	Energy: 210 HZ: 7	Energy: 210 HZ: 7
Armpit	Energy: 245 HZ: 7	Energy: 238 HZ: 7	Energy: 238 HZ: 7	Energy: 231 HZ: 7	Energy: 231 HZ: 7	Energy: 210 HZ: 7
Hairline	Energy: 210 HZ: 7	Energy: 203 HZ: 7	Energy: 196 HZ: 7	Energy: 189 HZ: 7	Energy: 189 HZ: 7	Energy: 175 HZ: 7
Bikini	Energy: 203 HZ: 7	Energy: 196 HZ: 7	Energy: 189 HZ: 7	Energy: 189 HZ: 7	Energy: 182 HZ: 7	Energy: 182 HZ: 7
Thigh	Energy: 245 HZ: 7	Energy: 245 HZ: 7	Energy: 238 HZ: 7	Energy: 231 HZ: 7	Energy: 231 HZ: 7	Energy: 210 HZ: 7
Leg	Energy: 238 HZ: 7	Energy: 231 HZ: 7	Energy: 231 HZ: 7	Energy: 289 HZ: 7	Energy: 189 HZ: 7	Energy: 238 HZ: 7

Spot size (mm²) 12*20
 Frequency 8HZ

FEMALE	I	II	III	IV	V	VI
Whiskers	Energy: 280 HZ: 8	Energy: 272 HZ: 8	Energy: 248 HZ: 8	Energy: 216 HZ: 8	Energy: 200 HZ: 8	Energy: 200 HZ: 8
Armpit	Energy: 280 HZ: 8	Energy: 280 HZ: 8	Energy: 272 HZ: 8	Energy: 240 HZ: 8	Energy: 240 HZ: 8	Energy: 240 HZ: 8
Hairline	Energy: 216 HZ: 8	Energy: 208 HZ: 8	Energy: 208 HZ: 8	Energy: 200 HZ: 8	Energy: 200 HZ: 8	Energy: 200 HZ: 8
Bikini	Energy: 240 HZ: 8	Energy: 232 HZ: 8	Energy: 224 HZ: 8	Energy: 208 HZ: 8	Energy: 200 HZ: 8	Energy: 200 HZ: 8
Thigh	Energy: 280 HZ: 8	Energy: 272 HZ: 8	Energy: 264 HZ: 8	Energy: 224 HZ: 8	Energy: 216 HZ: 8	Energy: 208 HZ: 8
Leg	Energy: 272 HZ: 8	Energy: 264 HZ: 8	Energy: 248 HZ: 8	Energy: 240 HZ: 1	Energy: 216 HZ: 8	Energy: 216 HZ: 8

MAN	I	II	III	IV	V	VI
Face	Energy: 272 HZ: 8	Energy: 248 HZ: 8	Energy: 248 HZ: 8	Energy: 240 HZ: 8	Energy: 240 HZ: 8	Energy: 240 HZ: 8
Armpit	Energy: 280 HZ: 8	Energy: 272 HZ: 8	Energy: 272 HZ: 8	Energy: 264 HZ: 8	Energy: 264 HZ: 8	Energy: 240 HZ: 8
Hairline	Energy: 240 HZ: 8	Energy: 232 HZ: 8	Energy: 224 HZ: 8	Energy: 216 HZ: 8	Energy: 216 HZ: 8	Energy: 200 HZ: 8
Bikini	Energy: 232 HZ: 8	Energy: 224 HZ: 8	Energy: 216 HZ: 8	Energy: 216 HZ: 8	Energy: 208 HZ: 8	Energy: 208 HZ: 8
Thigh	Energy: 280 HZ: 8	Energy: 280 HZ: 8	Energy: 272 HZ: 8	Energy: 264 HZ: 8	Energy: 264 HZ: 8	Energy: 240 HZ: 8
Leg	Energy: 272 HZ: 8	Energy: 264 HZ: 8	Energy: 264 HZ: 8	Energy: 216 HZ: 8	Energy: 216 HZ: 8	Energy: 272 HZ: 8

755/808/1064 Diode laser treatment parameters (14*14)

Spot size (mm ²)		14*14				
Frequency		1HZ				
MAN	I	II	III	IV	V	VI
Face	Energy: 28 HZ: 1	Energy: 25 HZ: 1	Energy: 25 HZ: 1	Energy: 25 HZ: 1	Energy: 25 HZ: 1	Energy: 25 HZ: 1
Armpit	Energy: 29 HZ: 1	Energy: 28 HZ: 1	Energy: 28 HZ: 1	Energy: 27 HZ: 1	Energy: 27 HZ: 1	Energy: 25 HZ: 1
Hairline	Energy: 25 HZ: 1	Energy: 24 HZ: 1	Energy: 23 HZ: 1	Energy: 22 HZ: 1	Energy: 22 HZ: 1	Energy: 20 HZ: 1
Bikini	Energy: 24 HZ: 1	Energy: 23 HZ: 1	Energy: 22 HZ: 1	Energy: 22 HZ: 1	Energy: 21 HZ: 1	Energy: 21 HZ: 1
Thigh	Energy: 29 HZ: 1	Energy: 29 HZ: 1	Energy: 28 HZ: 1	Energy: 23 HZ: 1	Energy: 27 HZ: 1	Energy: 25 HZ: 1
Leg	Energy: 28 HZ: 1	Energy: 27 HZ: 1	Energy: 27 HZ: 1	Energy: 22 HZ: 1	Energy: 22 HZ: 1	Energy: 28 HZ: 1

FEMALE	I	II	III	IV	V	VI
Whiskers	Energy: 29 HZ: 1	Energy: 28 HZ: 1	Energy: 25 HZ: 1	Energy: 22 HZ: 1	Energy: 20 HZ: 1	Energy: 20 HZ: 1
Armpit	Energy: 29 HZ: 1	Energy: 29 HZ: 1	Energy: 28 HZ: 1	Energy: 25 HZ: 1	Energy: 25 HZ: 1	Energy: 25 HZ: 1
Hairline	Energy: 22 HZ: 1	Energy: 21 HZ: 1	Energy: 21 HZ: 1	Energy: 20 HZ: 1	Energy: 20 HZ: 1	Energy: 20 HZ: 1
Bikini	Energy: 25 HZ: 1	Energy: 24 HZ: 1	Energy: 23 HZ: 1	Energy: 21 HZ: 1	Energy: 20 HZ: 1	Energy: 20 HZ: 1
Thigh	Energy: 29 HZ: 1	Energy: 28 HZ: 1	Energy: 27 HZ: 1	Energy: 23 HZ: 1	Energy: 22 HZ: 1	Energy: 21 HZ: 1
Leg	Energy: 28 HZ: 1	Energy: 27 HZ: 1	Energy: 25 HZ: 1	Energy: 25 HZ: 1	Energy: 22 HZ: 1	Energy: 22 HZ: 1

Spot size (mm²) 14*14
Frequency 2HZ

MAN	I	II	III	IV	V	VI
Face	Energy: 56 HZ: 2	Energy: 51 HZ: 2	Energy: 51 HZ: 2	Energy: 49 HZ: 2	Energy: 49 HZ: 2	Energy: 49 HZ: 2
Armpit	Energy: 57 HZ: 2	Energy: 56 HZ: 2	Energy: 56 HZ: 2	Energy: 54 HZ: 2	Energy: 54 HZ: 2	Energy: 49 HZ: 2
Hairline	Energy: 49 HZ: 2	Energy: 47 HZ: 2	Energy: 46 HZ: 2	Energy: 44 HZ: 2	Energy: 44 HZ: 2	Energy: 41 HZ: 2
Bikini	Energy: 47 HZ: 2	Energy: 46 HZ: 2	Energy: 44 HZ: 2	Energy: 44 HZ: 2	Energy: 42 HZ: 2	Energy: 42 HZ: 2
Thigh	Energy: 57 HZ: 2	Energy: 57 HZ: 2	Energy: 56 HZ: 2	Energy: 54 HZ: 2	Energy: 54 HZ: 2	Energy: 49 HZ: 2
Leg	Energy: 56 HZ: 2	Energy: 54 HZ: 2	Energy: 54 HZ: 2	Energy: 44 HZ: 2	Energy: 44 HZ: 2	Energy: 56 HZ: 2

FEMALE	I	II	III	IV	V	VI
Whiskers	Energy: 57 HZ: 2	Energy: 56 HZ: 2	Energy: 51 HZ: 2	Energy: 44 HZ: 2	Energy: 41 HZ: 2	Energy: 41 HZ: 2
Armpit	Energy: 57 HZ: 2	Energy: 57 HZ: 2	Energy: 56 HZ: 2	Energy: 49 HZ: 2	Energy: 49 HZ: 2	Energy: 49 HZ: 2
Hairline	Energy: 44 HZ: 2	Energy: 42 HZ: 2	Energy: 42 HZ: 2	Energy: 41 HZ: 2	Energy: 41 HZ: 2	Energy: 41 HZ: 2
Bikini	Energy: 49 HZ: 2	Energy: 47 HZ: 2	Energy: 46 HZ: 2	Energy: 42 HZ: 2	Energy: 41 HZ: 2	Energy: 41 HZ: 2
Thigh	Energy: 57 HZ: 2	Energy: 56 HZ: 2	Energy: 54 HZ: 2	Energy: 46 HZ: 2	Energy: 44 HZ: 2	Energy: 42 HZ: 2
Leg	Energy: 56 HZ: 2	Energy: 54 HZ: 2	Energy: 51 HZ: 2	Energy: 49 HZ: 2	Energy: 44 HZ: 2	Energy: 44 HZ: 2

Spot size (mm²) 14*14
 Frequency 3HZ

FEMALE	I	II	III	IV	V	VI
Whiskers	Energy: 86	Energy: 83	Energy: 76	Energy: 66	Energy: 61	Energy: 61
	HZ: 3	HZ: 3	HZ: 3	HZ: 3	HZ: 3	HZ: 3
Armpit	Energy: 86	Energy: 86	Energy: 83	Energy: 74	Energy: 74	Energy: 74
	HZ: 3	HZ: 3	HZ: 3	HZ: 3	HZ: 3	HZ: 3
Hairline	Energy: 66	Energy: 64	Energy: 64	Energy: 61	Energy: 61	Energy: 61
	HZ: 3	HZ: 3	HZ: 3	HZ: 3	HZ: 3	HZ: 3
Bikini	Energy: 74	Energy: 71	Energy: 69	Energy: 64	Energy: 61	Energy: 61
	HZ: 3	HZ: 3	HZ: 3	HZ: 3	HZ: 3	HZ: 3
Thigh	Energy: 86	Energy: 83	Energy: 81	Energy: 69	Energy: 66	Energy: 64
	HZ: 3	HZ: 3	HZ: 3	HZ: 3	HZ: 3	HZ: 3
Leg	Energy: 83	Energy: 81	Energy: 76	Energy: 74	Energy: 66	Energy: 66
	HZ: 3	HZ: 3	HZ: 3	HZ: 3	HZ: 3	HZ: 3

MAN	I	II	III	IV	V	VI
Face	Energy: 83	Energy: 76	Energy: 76	Energy: 74	Energy: 74	Energy: 74
	HZ: 3	HZ: 3	HZ: 3	HZ: 3	HZ: 3	HZ: 3
Armpit	Energy: 86	Energy: 83.3	Energy: 83.3	Energy: 81	Energy: 81	Energy: 74
	HZ: 3	HZ: 3	HZ: 3	HZ: 3	HZ: 3	HZ: 3
Hairline	Energy: 74	Energy: 63.7	Energy: 68.6	Energy: 66	Energy: 66	Energy: 61
	HZ: 3	HZ: 3	HZ: 3	HZ: 3	HZ: 3	HZ: 3
Bikini	Energy: 64	Energy: 68.6	Energy: 66.2	Energy: 66	Energy: 64	Energy: 64
	HZ: 3	HZ: 3	HZ: 3	HZ: 3	HZ: 3	HZ: 3
Thigh	Energy: 86	Energy: 85.8	Energy: 83.3	Energy: 81	Energy: 81	Energy: 74
	HZ: 3	HZ: 3	HZ: 3	HZ: 3	HZ: 3	HZ: 3
Leg	Energy: 83	Energy: 80.9	Energy: 80.9	Energy: 66	Energy: 66	Energy: 83
	HZ: 3	HZ: 3	HZ: 3	HZ: 3	HZ: 3	HZ: 3

Spot size (mm²) 14*14
Frequency 4HZ

FEMALE	I	II	III	IV	V	VI
Whiskers	Energy: 114 HZ: 4	Energy: 111 HZ: 4	Energy: 101 HZ: 4	Energy: 88 HZ: 4	Energy: 82 HZ: 4	Energy: 82 HZ: 4
Armpit	Energy: 114 HZ: 4	Energy: 114 HZ: 4	Energy: 111 HZ: 4	Energy: 98 HZ: 4	Energy: 98 HZ: 4	Energy: 98 HZ: 4
Hairline	Energy: 88 HZ: 4	Energy: 85 HZ: 4	Energy: 85 HZ: 4	Energy: 82 HZ: 4	Energy: 82 HZ: 4	Energy: 82 HZ: 4
Bikini	Energy: 98 HZ: 4	Energy: 95 HZ: 4	Energy: 91 HZ: 4	Energy: 85 HZ: 4	Energy: 82 HZ: 4	Energy: 82 HZ: 4
Thigh	Energy: 114 HZ: 4	Energy: 111 HZ: 4	Energy: 108 HZ: 4	Energy: 91 HZ: 4	Energy: 88 HZ: 4	Energy: 85 HZ: 4
Leg	Energy: 111 HZ: 4	Energy: 108 HZ: 4	Energy: 101 HZ: 4	Energy: 98 HZ: 4	Energy: 88 HZ: 4	Energy: 88 HZ: 4

MAN	I	II	III	IV	V	VI
Face	Energy: 111 HZ: 4	Energy: 101 HZ: 4	Energy: 101 HZ: 4	Energy: 98 HZ: 4	Energy: 98 HZ: 4	Energy: 98 HZ: 4
Armpit	Energy: 114 HZ: 4	Energy: 111 HZ: 4	Energy: 111 HZ: 4	Energy: 108 HZ: 4	Energy: 108 HZ: 4	Energy: 98 HZ: 4
Hairline	Energy: 98 HZ: 4	Energy: 95 HZ: 4	Energy: 91 HZ: 4	Energy: 88 HZ: 4	Energy: 88 HZ: 4	Energy: 82 HZ: 4
Bikini	Energy: 95 HZ: 3	Energy: 91 HZ: 3	Energy: 88 HZ: 3	Energy: 88 HZ: 3	Energy: 85 HZ: 3	Energy: 88 HZ: 3
Thigh	Energy: 114 HZ: 4	Energy: 114 HZ: 4	Energy: 111 HZ: 4	Energy: 108 HZ: 4	Energy: 108 HZ: 4	Energy: 98 HZ: 4
Leg	Energy: 111 HZ: 4	Energy: 108 HZ: 4	Energy: 108 HZ: 4	Energy: 88 HZ: 4	Energy: 88 HZ: 4	Energy: 111 HZ: 4

Spot size (mm²) 14*14
 Frequency 5HZ

FEMALE	I	II	III	IV	V	VI
Whiskers	Energy: 143 HZ: 5	Energy: 139 HZ: 5	Energy: 127 HZ: 5	Energy: 110 HZ: 5	Energy: 102 HZ: 5	Energy: 102 HZ: 5
Armpit	Energy: 143 HZ: 5	Energy: 143 HZ: 5	Energy: 139 HZ: 5	Energy: 123 HZ: 5	Energy: 123 HZ: 5	Energy: 123 HZ: 5
Hairline	Energy: 110 HZ: 5	Energy: 106 HZ: 5	Energy: 106 HZ: 5	Energy: 102 HZ: 5	Energy: 102 HZ: 5	Energy: 102 HZ: 5
Bikini	Energy: 123 HZ: 5	Energy: 118 HZ: 5	Energy: 114 HZ: 5	Energy: 106 HZ: 5	Energy: 102 HZ: 5	Energy: 102 HZ: 5
Thigh	Energy: 143 HZ: 5	Energy: 139 HZ: 5	Energy: 135 HZ: 5	Energy: 114 HZ: 5	Energy: 110 HZ: 5	Energy: 106 HZ: 5
Leg	Energy: 139 HZ: 5	Energy: 135 HZ: 5	Energy: 127 HZ: 5	Energy: 123 HZ: 5	Energy: 110 HZ: 5	Energy: 110 HZ: 5

MAN	I	II	III	IV	V	VI
Face	Energy: 139 HZ: 5	Energy: 127 HZ: 5	Energy: 127 HZ: 5	Energy: 123 HZ: 5	Energy: 110 HZ: 5	Energy: 123 HZ: 5
Armpit	Energy: 139 HZ: 5	Energy: 139 HZ: 5	Energy: 139 HZ: 5	Energy: 135 HZ: 5	Energy: 135 HZ: 5	Energy: 123 HZ: 5
Hairline	Energy: 123 HZ: 5	Energy: 118 HZ: 5	Energy: 114 HZ: 5	Energy: 110 HZ: 5	Energy: 110 HZ: 5	Energy: 102 HZ: 5
Bikini	Energy: 118 HZ: 5	Energy: 114 HZ: 5	Energy: 110 HZ: 5	Energy: 110 HZ: 5	Energy: 106 HZ: 5	Energy: 106 HZ: 5
Thigh	Energy: 143 HZ: 5	Energy: 143 HZ: 5	Energy: 139 HZ: 5	Energy: 135 HZ: 5	Energy: 135 HZ: 5	Energy: 123 HZ: 5
Leg	Energy: 139 HZ: 5	Energy: 135 HZ: 5	Energy: 135 HZ: 5	Energy: 110 HZ: 5	Energy: 114 HZ: 5	Energy: 139 HZ: 5

Spot size (mm²) 12*24
Frequency 6HZ

FEMALE	I	II	III	IV	V	VI
Whiskers	Energy: 172 HZ: 6	Energy: 167 HZ: 6	Energy: 152 HZ: 6	Energy: 132 HZ: 6	Energy: 123 HZ: 6	Energy: 123 HZ: 6
Armpit	Energy: 172 HZ: 6	Energy: 172 HZ: 6	Energy: 167 HZ: 6	Energy: 147 HZ: 6	Energy: 147 HZ: 6	Energy: 147 HZ: 6
Hairline	Energy: 132 HZ: 6	Energy: 127 HZ: 6	Energy: 127 HZ: 6	Energy: 123 HZ: 6	Energy: 123 HZ: 6	Energy: 143 HZ: 6
Bikini	Energy: 147 HZ: 6	Energy: 142 HZ: 6	Energy: 137 HZ: 6	Energy: 127 HZ: 6	Energy: 123 HZ: 6	Energy: 123 HZ: 6
Thigh	Energy: 172 HZ: 6	Energy: 167 HZ: 6	Energy: 162 HZ: 6	Energy: 137 HZ: 6	Energy: 132 HZ: 6	Energy: 127 HZ: 6
Leg	Energy: 167 HZ: 6	Energy: 162 HZ: 6	Energy: 152 HZ: 6	Energy: 147 HZ: 6	Energy: 132 HZ: 6	Energy: 132 HZ: 6

MAN	I	II	III	IV	V	VI
Face	Energy: 167 HZ: 6	Energy: 152 HZ: 6	Energy: 152 HZ: 6	Energy: 147 HZ: 6	Energy: 147 HZ: 6	Energy: 147 HZ: 6
Armpit	Energy: 172 HZ: 6	Energy: 167 HZ: 6	Energy: 167 HZ: 6	Energy: 162 HZ: 6	Energy: 162 HZ: 6	Energy: 147 HZ: 6
Hairline	Energy: 147 HZ: 6	Energy: 142 HZ: 6	Energy: 137 HZ: 6	Energy: 132 HZ: 6	Energy: 132 HZ: 6	Energy: 123 HZ: 6
Bikini	Energy: 142 HZ: 6	Energy: 137 HZ: 6	Energy: 132 HZ: 6	Energy: 132 HZ: 6	Energy: 127 HZ: 6	Energy: 127 HZ: 6
Thigh	Energy: 172 HZ: 6	Energy: 172 HZ: 6	Energy: 167 HZ: 6	Energy: 162 HZ: 6	Energy: 162 HZ: 6	Energy: 147 HZ: 6
Leg	Energy: 167 HZ: 6	Energy: 162 HZ: 6	Energy: 162 HZ: 6	Energy: 132 HZ: 6	Energy: 132 HZ: 6	Energy: 167 HZ: 6

Spot size (mm²) 14*14
Frequency 7HZ

FEMALE	I	II	III	IV	V	VI
Whiskers	Energy: 200 HZ: 7	Energy: 194 HZ: 7	Energy: 177 HZ: 7	Energy: 154 HZ: 7	Energy: 143 HZ: 7	Energy: 143 HZ: 7
Armpit	Energy: 200 HZ: 7	Energy: 200 HZ: 7	Energy: 194 HZ: 7	Energy: 172 HZ: 7	Energy: 172 HZ: 7	Energy: 172 HZ: 7
Hairline	Energy: 154 HZ: 7	Energy: 149 HZ: 7	Energy: 149 HZ: 7	Energy: 143 HZ: 7	Energy: 143 HZ: 7	Energy: 143 HZ: 7
Bikini	Energy: 172 HZ: 7	Energy: 166 HZ: 7	Energy: 160 HZ: 7	Energy: 149 HZ: 7	Energy: 143 HZ: 7	Energy: 143 HZ: 7
Thigh	Energy: 200 HZ: 7	Energy: 194 HZ: 7	Energy: 189 HZ: 7	Energy: 160 HZ: 7	Energy: 154 HZ: 7	Energy: 149 HZ: 7
Leg	Energy: 194 HZ: 7	Energy: 189 HZ: 7	Energy: 177 HZ: 7	Energy: 172 HZ: 7	Energy: 154 HZ: 7	Energy: 154 HZ: 7

MAN	I	II	III	IV	V	VI
Face	Energy: 194 HZ: 7	Energy: 177 HZ: 7	Energy: 177 HZ: 7	Energy: 172 HZ: 7	Energy: 172 HZ: 7	Energy: 172 HZ: 7
Armpit	Energy: 200 HZ: 7	Energy: 194 HZ: 7	Energy: 194 HZ: 7	Energy: 189 HZ: 7	Energy: 189 HZ: 7	Energy: 172 HZ: 7
Hairline	Energy: 172 HZ: 7	Energy: 166 HZ: 7	Energy: 160 HZ: 7	Energy: 154 HZ: 7	Energy: 154 HZ: 7	Energy: 143 HZ: 7
Bikini	Energy: 166 HZ: 7	Energy: 160 HZ: 7	Energy: 154 HZ: 7	Energy: 154 HZ: 7	Energy: 149 HZ: 7	Energy: 149 HZ: 7
Thigh	Energy: 200 HZ: 7	Energy: 200 HZ: 7	Energy: 194 HZ: 7	Energy: 189 HZ: 7	Energy: 189 HZ: 7	Energy: 172 HZ: 7
Leg	Energy: 194 HZ: 7	Energy: 189 HZ: 7	Energy: 189 HZ: 7	Energy: 236 HZ: 7	Energy: 154 HZ: 7	Energy: 194 HZ: 7

Spot size (mm²) 14*14
Frequency 8HZ

FEMALE	I	II	III	IV	V	VI
Whiskers	Energy: 229	Energy: 222	Energy: 203	Energy: 176	Energy: 163	Energy: 163
	HZ: 8	HZ: 8	HZ: 8	HZ: 8	HZ: 8	HZ: 8
Armpit	Energy: 229	Energy: 229	Energy: 222	Energy: 196	Energy: 196	Energy: 196
	HZ: 8	HZ: 8	HZ: 8	HZ: 8	HZ: 8	HZ: 8
Hairline	Energy: 176	Energy: 170	Energy: 170	Energy: 163	Energy: 163	Energy: 163
	HZ: 8	HZ: 8	HZ: 8	HZ: 8	HZ: 8	HZ: 8
Bikini	Energy: 196	Energy: 189	Energy: 183	Energy: 170	Energy: 163	Energy: 163
	HZ: 8	HZ: 8	HZ: 8	HZ: 8	HZ: 8	HZ: 8
Thigh	Energy: 229	Energy: 222	Energy: 216	Energy: 183	Energy: 176	Energy: 170
	HZ: 8	HZ: 8	HZ: 8	HZ: 8	HZ: 8	HZ: 8
Leg	Energy: 222	Energy: 216	Energy: 203	Energy: 196	Energy: 176	Energy: 176
	HZ: 8	HZ: 8	HZ: 8	HZ: 8	HZ: 8	HZ: 8

MAN	I	II	III	IV	V	VI
Face	Energy: 222	Energy: 203	Energy: 203	Energy: 196	Energy: 196	Energy: 196
	HZ: 8	HZ: 8	HZ: 8	HZ: 8	HZ: 8	HZ: 8
Armpit	Energy: 229	Energy: 222	Energy: 222	Energy: 216	Energy: 216	Energy: 196
	HZ: 8	HZ: 8	HZ: 8	HZ: 8	HZ: 8	HZ: 8
Hairline	Energy: 196	Energy: 189	Energy: 183	Energy: 176	Energy: 176	Energy: 163
	HZ: 8	HZ: 8	HZ: 8	HZ: 8	HZ: 8	HZ: 8
Bikini	Energy: 189	Energy: 183	Energy: 176	Energy: 176	Energy: 170	Energy: 170
	HZ: 8	HZ: 8	HZ: 8	HZ: 8	HZ: 8	HZ: 8
Thigh	Energy: 229	Energy: 229	Energy: 222	Energy: 216	Energy: 216	Energy: 196
	HZ: 8	HZ: 8	HZ: 8	HZ: 8	HZ: 8	HZ: 8
Leg	Energy: 222	Energy: 216	Energy: 216	Energy: 176	Energy: 176	Energy: 222
	HZ: 8	HZ: 8	HZ: 8	HZ: 8	HZ: 8	HZ: 8

755/808/1064 Diode laser treatment parameters (15*27)

Spot size (mm ²) Frequency		15*27 1HZ				
MAN	I	II	III	IV	V	VI
Face	Energy: 53 HZ: 1	Energy: 48 HZ: 1	Energy: 48 HZ: 1	Energy: 47 HZ: 1	Energy: 47 HZ: 1	Energy: 47 HZ: 1
Armpit	Energy: 55 HZ: 1	Energy: 53 HZ: 1	Energy: 53 HZ: 1	Energy: 52 HZ: 1	Energy: 52 HZ: 1	Energy: 47 HZ: 1
Hairline	Energy: 47 HZ: 1	Energy: 45 HZ: 1	Energy: 44 HZ: 1	Energy: 42 HZ: 1	Energy: 42 HZ: 1	Energy: 39 HZ: 1
Bikini	Energy: 45 HZ: 1	Energy: 44 HZ: 1	Energy: 42 HZ: 1	Energy: 42 HZ: 1	Energy: 41 HZ: 1	Energy: 41 HZ: 1
Thigh	Energy: 55 HZ: 1	Energy: 55 HZ: 1	Energy: 53 HZ: 1	Energy: 52 HZ: 1	Energy: 52 HZ: 1	Energy: 47 HZ: 1
Leg	Energy: 53 HZ: 1	Energy: 52 HZ: 1	Energy: 52 HZ: 1	Energy: 42 HZ: 1	Energy: 42 HZ: 1	Energy: 53 HZ: 1

FEMALE	I	II	III	IV	V	VI
Whiskers	Energy: 55 HZ: 1	Energy: 53 HZ: 1	Energy: 48 HZ: 1	Energy: 42 HZ: 1	Energy: 39 HZ: 1	Energy: 39 HZ: 1
Armpit	Energy: 55 HZ: 1	Energy: 55 HZ: 1	Energy: 53 HZ: 1	Energy: 47 HZ: 1	Energy: 47 HZ: 1	Energy: 47 HZ: 1
Hairline	Energy: 42 HZ: 1	Energy: 41 HZ: 1	Energy: 41 HZ: 1	Energy: 39 HZ: 1	Energy: 39 HZ: 1	Energy: 39 HZ: 1
Bikini	Energy: 47 HZ: 1	Energy: 45 HZ: 1	Energy: 44 HZ: 1	Energy: 41 HZ: 1	Energy: 39 HZ: 1	Energy: 39 HZ: 1
Thigh	Energy: 55 HZ: 1	Energy: 53 HZ: 1	Energy: 52 HZ: 1	Energy: 44 HZ: 1	Energy: 42 HZ: 1	Energy: 41 HZ: 1
Leg	Energy: 53 HZ: 1	Energy: 52 HZ: 1	Energy: 48 HZ: 1	Energy: 47 HZ: 1	Energy: 42 HZ: 1	Energy: 42 HZ: 1

Spot size (mm²) 15*27
 Frequency 2HZ

MAN	I	II	III	IV	V	VI
Face	Energy: 106 HZ: 2	Energy: 97 HZ: 2	Energy: 97 HZ: 2	Energy: 94 HZ: 2	Energy: 94 HZ: 2	Energy: 94 HZ: 2
Armpit	Energy: 109 HZ: 2	Energy: 106 HZ: 2	Energy: 106 HZ: 2	Energy: 103 HZ: 2	Energy: 103 HZ: 2	Energy: 94 HZ: 2
Hairline	Energy: 94 HZ: 2	Energy: 91 HZ: 2	Energy: 88 HZ: 2	Energy: 84 HZ: 2	Energy: 84 HZ: 2	Energy: 78 HZ: 2
Bikini	Energy: 91 HZ: 2	Energy: 88 HZ: 2	Energy: 84 HZ: 2	Energy: 84 HZ: 2	Energy: 81 HZ: 2	Energy: 81 HZ: 2
Thigh	Energy: 109 HZ: 2	Energy: 109 HZ: 2	Energy: 106 HZ: 2	Energy: 103 HZ: 2	Energy: 103 HZ: 2	Energy: 94 HZ: 2
Leg	Energy: 106 HZ: 2	Energy: 103 HZ: 2	Energy: 103 HZ: 2	Energy: 84 HZ: 2	Energy: 84 HZ: 2	Energy: 106 HZ: 2

FEMALE	I	II	III	IV	V	VI
Whiskers	Energy: 109 HZ: 2	Energy: 106 HZ: 2	Energy: 97 HZ: 2	Energy: 84 HZ: 2	Energy: 78 HZ: 2	Energy: 78 HZ: 2
Armpit	Energy: 109 HZ: 2	Energy: 109 HZ: 2	Energy: 106 HZ: 2	Energy: 94 HZ: 2	Energy: 94 HZ: 2	Energy: 94 HZ: 2
Hairline	Energy: 84 HZ: 2	Energy: 81 HZ: 2	Energy: 81 HZ: 2	Energy: 78 HZ: 2	Energy: 78 HZ: 2	Energy: 78 HZ: 2
Bikini	Energy: 94 HZ: 2	Energy: 91 HZ: 2	Energy: 88 HZ: 2	Energy: 81 HZ: 2	Energy: 78 HZ: 2	Energy: 78 HZ: 2
Thigh	Energy: 109 HZ: 2	Energy: 106 HZ: 2	Energy: 103 HZ: 2	Energy: 88 HZ: 2	Energy: 84 HZ: 2	Energy: 81 HZ: 2
Leg	Energy: 106 HZ: 2	Energy: 103 HZ: 2	Energy: 97 HZ: 2	Energy: 94 HZ: 2	Energy: 84 HZ: 2	Energy: 84 HZ: 2

Spot size (mm²) 15*27
 Frequency 3HZ

FEMALE	I	II	III	IV	V	VI
Whiskers	Energy: 164 HZ: 3	Energy: 159 HZ: 3	Energy: 145 HZ: 3	Energy: 127 HZ: 3	Energy: 117 HZ: 3	Energy: 117 HZ: 3
Armpit	Energy: 164 HZ: 3	Energy: 164 HZ: 3	Energy: 159 HZ: 3	Energy: 141 HZ: 3	Energy: 141 HZ: 3	Energy: 141 HZ: 3
Hairline	Energy: 127 HZ: 3	Energy: 122 HZ: 3	Energy: 122 HZ: 3	Energy: 117 HZ: 3	Energy: 117 HZ: 3	Energy: 117 HZ: 3
Bikini	Energy: 141 HZ: 3	Energy: 136 HZ: 3	Energy: 131 HZ: 3	Energy: 122 HZ: 3	Energy: 117 HZ: 3	Energy: 117 HZ: 3
Thigh	Energy: 164 HZ: 3	Energy: 159 HZ: 3	Energy: 155 HZ: 3	Energy: 131 HZ: 3	Energy: 127 HZ: 3	Energy: 122 HZ: 3
Leg	Energy: 159 HZ: 3	Energy: 155 HZ: 3	Energy: 145 HZ: 3	Energy: 141 HZ: 3	Energy: 127 HZ: 3	Energy: 127 HZ: 3

MAN	I	II	III	IV	V	VI
Face	Energy: 159 HZ: 3	Energy: 145 HZ: 3	Energy: 145 HZ: 3	Energy: 141 HZ: 3	Energy: 141 HZ: 3	Energy: 141 HZ: 3
Armpit	Energy: 164 HZ: 3	Energy: 159 HZ: 3	Energy: 159 HZ: 3	Energy: 155 HZ: 3	Energy: 155 HZ: 3	Energy: 141 HZ: 3
Hairline	Energy: 141 HZ: 3	Energy: 122 HZ: 3	Energy: 131 HZ: 3	Energy: 127 HZ: 3	Energy: 127 HZ: 3	Energy: 117 HZ: 3
Bikini	Energy: 122 HZ: 3	Energy: 131 HZ: 3	Energy: 127 HZ: 3	Energy: 127 HZ: 3	Energy: 122 HZ: 3	Energy: 122 HZ: 3
Thigh	Energy: 164 HZ: 3	Energy: 164 HZ: 3	Energy: 159 HZ: 3	Energy: 155 HZ: 3	Energy: 155 HZ: 3	Energy: 141 HZ: 3
Leg	Energy: 159 HZ: 3	Energy: 155 HZ: 3	Energy: 155 HZ: 3	Energy: 127 HZ: 3	Energy: 127 HZ: 3	Energy: 159 HZ: 3

Spot size (mm²) 15*27
 Frequency 4HZ

FEMALE	I	II	III	IV	V	VI
Whiskers	Energy: 219 HZ: 4	Energy: 213 HZ: 4	Energy: 194 HZ: 4	Energy: 169 HZ: 4	Energy: 156 HZ: 4	Energy: 156 HZ: 4
Armpit	Energy: 219 HZ: 4	Energy: 219 HZ: 4	Energy: 213 HZ: 4	Energy: 188 HZ: 4	Energy: 188 HZ: 4	Energy: 188 HZ: 4
Hairline	Energy: 169 HZ: 4	Energy: 163 HZ: 4	Energy: 163 HZ: 4	Energy: 156 HZ: 4	Energy: 156 HZ: 4	Energy: 156 HZ: 4
Bikini	Energy: 188 HZ: 4	Energy: 181 HZ: 4	Energy: 175 HZ: 4	Energy: 163 HZ: 4	Energy: 156 HZ: 4	Energy: 156 HZ: 4
Thigh	Energy: 219 HZ: 4	Energy: 213 HZ: 4	Energy: 206 HZ: 4	Energy: 175 HZ: 4	Energy: 169 HZ: 4	Energy: 163 HZ: 4
Leg	Energy: 213 HZ: 4	Energy: 206 HZ: 4	Energy: 194 HZ: 4	Energy: 188 HZ: 4	Energy: 169 HZ: 4	Energy: 169 HZ: 4

MAN	I	II	III	IV	V	VI
Face	Energy: 213 HZ: 4	Energy: 194 HZ: 4	Energy: 194 HZ: 4	Energy: 308 HZ: 8	Energy: 188 HZ: 4	Energy: 188 HZ: 4
Armpit	Energy: 219 HZ: 4	Energy: 213 HZ: 4	Energy: 213 HZ: 4	Energy: 338 HZ: 8	Energy: 206 HZ: 4	Energy: 188 HZ: 4
Hairline	Energy: 188 HZ: 4	Energy: 181 HZ: 4	Energy: 175 HZ: 4	Energy: 277 HZ: 8	Energy: 169 HZ: 4	Energy: 156 HZ: 4
Bikini	Energy: 181 HZ: 4	Energy: 175 HZ: 4	Energy: 169 HZ: 4	Energy: 277 HZ: 8	Energy: 163 HZ: 4	Energy: 169 HZ: 4
Thigh	Energy: 219 HZ: 4	Energy: 219 HZ: 4	Energy: 213 HZ: 4	Energy: 338 HZ: 8	Energy: 206 HZ: 4	Energy: 188 HZ: 4
Leg	Energy: 213 HZ: 5	Energy: 206 HZ: 5	Energy: 206 HZ: 5	Energy: 277 HZ: 9	Energy: 169 HZ: 5	Energy: 213 HZ: 5

Spot size (mm²) 15*27
 Frequency 5HZ

FEMALE	I	II	III	IV	V	VI
Whiskers	Energy: 273 HZ: 5	Energy: 266 HZ: 5	Energy: 242 HZ: 5	Energy: 211 HZ: 5	Energy: 195 HZ: 5	Energy: 195 HZ: 5
Armpit	Energy: 273 HZ: 5	Energy: 273 HZ: 5	Energy: 266 HZ: 5	Energy: 234 HZ: 5	Energy: 234 HZ: 5	Energy: 234 HZ: 5
Hairline	Energy: 211 HZ: 5	Energy: 203 HZ: 5	Energy: 203 HZ: 5	Energy: 195 HZ: 5	Energy: 195 HZ: 5	Energy: 195 HZ: 5
Bikini	Energy: 234 HZ: 5	Energy: 227 HZ: 5	Energy: 219 HZ: 5	Energy: 203 HZ: 5	Energy: 195 HZ: 5	Energy: 195 HZ: 5
Thigh	Energy: 273 HZ: 5	Energy: 266 HZ: 5	Energy: 258 HZ: 5	Energy: 219 HZ: 5	Energy: 211 HZ: 5	Energy: 203 HZ: 5
Leg	Energy: 266 HZ: 5	Energy: 258 HZ: 5	Energy: 242 HZ: 5	Energy: 234 HZ: 5	Energy: 211 HZ: 5	Energy: 211 HZ: 5

MAN	I	II	III	IV	V	VI
Face	Energy: 266 HZ: 5	Energy: 242 HZ: 5	Energy: 242 HZ: 5	Energy: 234 HZ: 5	Energy: 211 HZ: 5	Energy: 234 HZ: 5
Armpit	Energy: 266 HZ: 5	Energy: 266 HZ: 5	Energy: 266 HZ: 5	Energy: 258 HZ: 5	Energy: 258 HZ: 5	Energy: 234 HZ: 5
Hairline	Energy: 234 HZ: 5	Energy: 227 HZ: 5	Energy: 219 HZ: 5	Energy: 211 HZ: 5	Energy: 211 HZ: 5	Energy: 195 HZ: 5
Bikini	Energy: 227 HZ: 5	Energy: 219 HZ: 5	Energy: 211 HZ: 5	Energy: 211 HZ: 5	Energy: 203 HZ: 5	Energy: 203 HZ: 5
Thigh	Energy: 273 HZ: 5	Energy: 273 HZ: 5	Energy: 266 HZ: 5	Energy: 258 HZ: 5	Energy: 258 HZ: 5	Energy: 234 HZ: 5
Leg	Energy: 266 HZ: 5	Energy: 258 HZ: 5	Energy: 258 HZ: 5	Energy: 211 HZ: 5	Energy: 219 HZ: 5	Energy: 266 HZ: 5

Spot size (mm ²)		15*27				
Frequency		6HZ				
FEMALE	I	II	III	IV	V	VI
Whiskers	Energy: 328	Energy: 319	Energy: 291	Energy: 253	Energy: 234	Energy: 234
	HZ: 6	HZ: 6	HZ: 6	HZ: 6	HZ: 6	HZ: 6
Armpit	Energy: 328	Energy: 328	Energy: 319	Energy: 281	Energy: 281	Energy: 281
	HZ: 6	HZ: 6	HZ: 6	HZ: 6	HZ: 6	HZ: 6
Hairline	Energy: 253	Energy: 244	Energy: 244	Energy: 234	Energy: 234	Energy: 273
	HZ: 6	HZ: 6	HZ: 6	HZ: 6	HZ: 6	HZ: 6
Bikini	Energy: 281	Energy: 272	Energy: 263	Energy: 244	Energy: 234	Energy: 234
	HZ: 6	HZ: 6	HZ: 6	HZ: 6	HZ: 6	HZ: 6
Thigh	Energy: 328	Energy: 319	Energy: 309	Energy: 263	Energy: 253	Energy: 244
	HZ: 6	HZ: 6	HZ: 6	HZ: 6	HZ: 6	HZ: 6
Leg	Energy: 319	Energy: 309	Energy: 291	Energy: 281	Energy: 253	Energy: 253
	HZ: 6	HZ: 6	HZ: 6	HZ: 6	HZ: 6	HZ: 6

MAN	I	II	III	IV	V	VI
Face	Energy: 319	Energy: 291	Energy: 291	Energy: 281	Energy: 281	Energy: 281
	HZ: 6	HZ: 6	HZ: 6	HZ: 6	HZ: 6	HZ: 6
Armpit	Energy: 328	Energy: 319	Energy: 319	Energy: 309	Energy: 309	Energy: 281
	HZ: 6	HZ: 6	HZ: 6	HZ: 6	HZ: 6	HZ: 6
Hairline	Energy: 281	Energy: 272	Energy: 263	Energy: 253	Energy: 253	Energy: 234
	HZ: 6	HZ: 6	HZ: 6	HZ: 6	HZ: 6	HZ: 6
Bikini	Energy: 272	Energy: 263	Energy: 253	Energy: 253	Energy: 244	Energy: 244
	HZ: 6	HZ: 6	HZ: 6	HZ: 6	HZ: 6	HZ: 6
Thigh	Energy: 328	Energy: 328	Energy: 319	Energy: 309	Energy: 309	Energy: 281
	HZ: 6	HZ: 6	HZ: 6	HZ: 6	HZ: 6	HZ: 6
Leg	Energy: 319	Energy: 309	Energy: 309	Energy: 253	Energy: 253	Energy: 319
	HZ: 6	HZ: 6	HZ: 6	HZ: 6	HZ: 6	HZ: 6

HR mode treatment parameter : HR mode meaning you should treat same area within 1 second . For example : If you set 5Hz , should 5 shots in same area .

755/808/1064 Diode laser treatment parameters (1HZ)

MAN	I	II	III	IV	V	VI
Whiskers	Energy: 34 Pulsewidth: 85 HZ: 1	Energy: 31 Pulsewidth: 78 HZ: 1	Energy: 31 Pulsewidth: 78 HZ: 1	Energy: 30 Pulsewidth: 77 HZ: 1	Energy: 30 Pulsewidth: 77 HZ: 1	Energy: 30 Pulsewidth: 75 HZ: 1
Armpit	Energy: 35 Pulsewidth: 88 HZ: 1	Energy: 34 Pulsewidth: 86 HZ: 1	Energy: 34 Pulsewidth: 85 HZ: 1	Energy: 31 Pulsewidth: 79 HZ: 1	Energy: 31 Pulsewidth: 79 HZ: 1	Energy: 30 Pulsewidth: 76 HZ: 1
Hairline	Energy: 26 Pulsewidth: 65 HZ: 1	Energy: 25 Pulsewidth: 63 HZ: 1	Energy: 24 Pulsewidth: 62 HZ: 1	Energy: 22 Pulsewidth: 55 HZ: 1	Energy: 22 Pulsewidth: 55 HZ: 1	Energy: 20 Pulsewidth: 52 HZ: 1
Bikini	Energy: 29 Pulsewidth: 74 HZ: 1	Energy: 26 Pulsewidth: 65 HZ: 1	Energy: 25 Pulsewidth: 63 HZ: 1	Energy: 25 Pulsewidth: 63 HZ: 1	Energy: 23 Pulsewidth: 59 HZ: 1	Energy: 23 Pulsewidth: 59 HZ: 1
Thigh	Energy: 35 Pulsewidth: 89 HZ: 1	Energy: 35 Pulsewidth: 88 HZ: 1	Energy: 34 Pulsewidth: 85 HZ: 1	Energy: 30 Pulsewidth: 75 HZ: 1	Energy: 30 Pulsewidth: 75 HZ: 1	Energy: 30 Pulsewidth: 75 HZ: 1
Leg	Energy: 34 Pulsewidth: 85 HZ: 1	Energy: 30 Pulsewidth: 75 HZ: 1	Energy: 30 Pulsewidth: 75 HZ: 1	Energy: 27 Pulsewidth: 68 HZ: 1	Energy: 27 Pulsewidth: 68 HZ: 1	Energy: 23 Pulsewidth: 58 HZ: 1

FEMALE	I	II	III	IV	V	VI
Face	Energy: 35 Pulsewidth: 89 HZ: 1	Energy: 34 Pulsewidth: 86 HZ: 1	Energy: 31 Pulsewidth: 79 HZ: 1	Energy: 27 Pulsewidth: 68 HZ: 1	Energy: 23 Pulsewidth: 58 HZ: 1	Energy: 23 Pulsewidth: 58 HZ: 1
Armpit	Energy: 35 Pulsewidth: 89 HZ: 1	Energy: 35 Pulsewidth: 88 HZ: 1	Energy: 34 Pulsewidth: 85 HZ: 1	Energy: 30 Pulsewidth: 76 HZ: 1	Energy: 30 Pulsewidth: 76 HZ: 1	Energy: 30 Pulsewidth: 76 HZ: 1
Hairline	Energy: 27 Pulsewidth: 68 HZ: 1	Energy: 26 Pulsewidth: 67 HZ: 1	Energy: 26 Pulsewidth: 65 HZ: 1	Energy: 24 Pulsewidth: 61 HZ: 1	Energy: 23 Pulsewidth: 58 HZ: 1	Energy: 23 Pulsewidth: 58 HZ: 1
Bikini	Energy: 30 Pulsewidth: 75 HZ: 1	Energy: 29 Pulsewidth: 74 HZ: 1	Energy: 28 Pulsewidth: 72 HZ: 1	Energy: 26 Pulsewidth: 65 HZ: 1	Energy: 23 Pulsewidth: 58 HZ: 1	Energy: 23 Pulsewidth: 58 HZ: 1
Thigh	Energy: 35 Pulsewidth: 88 HZ: 1	Energy: 34 Pulsewidth: 86 HZ: 1	Energy: 33 Pulsewidth: 83 HZ: 1	Energy: 28 Pulsewidth: 72 HZ: 1	Energy: 26 Pulsewidth: 65 HZ: 1	Energy: 26 Pulsewidth: 65 HZ: 1
Leg	Energy: 34 Pulsewidth: 85 HZ: 1	Energy: 33 Pulsewidth: 83 HZ: 1	Energy: 31 Pulsewidth: 78 HZ: 1	Energy: 30 Pulsewidth: 75 HZ: 1	Energy: 27 Pulsewidth: 68 HZ: 1	Energy: 27 Pulsewidth: 68 HZ: 1

755/808/1064 Diode laser treatment parameters (5HZ)

MAN	I	II	III	IV	V	VI
Whiskers	Energy: 72 Pulsewidth: 36 HZ: 5	Energy: 72 Pulsewidth: 36 HZ: 5	Energy: 68 Pulsewidth: 34 HZ: 5	Energy: 64 Pulsewidth: 32 HZ: 5	Energy: 64 Pulsewidth: 32 HZ: 5	Energy: 56 Pulsewidth: 28 HZ: 5
Armpit	Energy: 74 Pulsewidth: 37 HZ: 5	Energy: 72 Pulsewidth: 36 HZ: 5	Energy: 68 Pulsewidth: 34 HZ: 5	Energy: 60 Pulsewidth: 30 HZ: 5	Energy: 60 Pulsewidth: 30 HZ: 5	Energy: 56 Pulsewidth: 28 HZ: 5
Hairline	Energy: 70 Pulsewidth: 35 HZ: 5	Energy: 68 Pulsewidth: 34 HZ: 5	Energy: 64 Pulsewidth: 32 HZ: 5	Energy: 60 Pulsewidth: 30 HZ: 5	Energy: 60 Pulsewidth: 30 HZ: 5	Energy: 58 Pulsewidth: 29 HZ: 5
Bikini	Energy: 70 Pulsewidth: 35 HZ: 5	Energy: 68 Pulsewidth: 34 HZ: 5	Energy: 64 Pulsewidth: 32 HZ: 5	Energy: 60 Pulsewidth: 30 HZ: 5	Energy: 60 Pulsewidth: 30 HZ: 5	Energy: 52 Pulsewidth: 26 HZ: 5
Thigh	Energy: 74 Pulsewidth: 37 HZ: 5	Energy: 72 Pulsewidth: 36 HZ: 5	Energy: 68 Pulsewidth: 34 HZ: 5	Energy: 64 Pulsewidth: 32 HZ: 5	Energy: 64 Pulsewidth: 32 HZ: 5	Energy: 60 Pulsewidth: 30 HZ: 5
Leg	Energy: 70 Pulsewidth: 35 HZ: 5	Energy: 68 Pulsewidth: 34 HZ: 5	Energy: 68 Pulsewidth: 34 HZ: 5	Energy: 64 Pulsewidth: 32 HZ: 5	Energy: 64 Pulsewidth: 32 HZ: 5	Energy: 52 Pulsewidth: 26 HZ: 5

FEMALE	I	II	III	IV	V	VI
Face	Energy: 74 Pulsewidth: 37 HZ: 5	Energy: 72 Pulsewidth: 36 HZ: 5	Energy: 72 Pulsewidth: 36 HZ: 5	Energy: 66 Pulsewidth: 33 HZ: 5	Energy: 66 Pulsewidth: 33 HZ: 5	Energy: 58 Pulsewidth: 29 HZ: 5
Armpit	Energy: 74 Pulsewidth: 37 HZ: 5	Energy: 72 Pulsewidth: 36 HZ: 5	Energy: 72 Pulsewidth: 36 HZ: 5	Energy: 64 Pulsewidth: 32 HZ: 5	Energy: 64 Pulsewidth: 32 HZ: 5	Energy: 58 Pulsewidth: 29 HZ: 5
Hairline	Energy: 68 Pulsewidth: 34 HZ: 5	Energy: 68 Pulsewidth: 34 HZ: 5	Energy: 68 Pulsewidth: 34 HZ: 5	Energy: 60 Pulsewidth: 30 HZ: 5	Energy: 60 Pulsewidth: 30 HZ: 5	Energy: 58 Pulsewidth: 29 HZ: 5
Bikini	Energy: 66 Pulsewidth: 33 HZ: 5	Energy: 64 Pulsewidth: 32 HZ: 5	Energy: 60 Pulsewidth: 30 HZ: 5	Energy: 56 Pulsewidth: 28 HZ: 5	Energy: 56 Pulsewidth: 28 HZ: 5	Energy: 52 Pulsewidth: 26 HZ: 5
Thigh	Energy: 74 Pulsewidth: 37 HZ: 5	Energy: 72 Pulsewidth: 36 HZ: 5	Energy: 68 Pulsewidth: 34 HZ: 5	Energy: 56 Pulsewidth: 28 HZ: 5	Energy: 56 Pulsewidth: 28 HZ: 5	Energy: 52 Pulsewidth: 26 HZ: 5
Leg	Energy: 72 Pulsewidth: 36 HZ: 5	Energy: 72 Pulsewidth: 36 HZ: 5	Energy: 68 Pulsewidth: 34 HZ: 5	Energy: 56 Pulsewidth: 28 HZ: 5	Energy: 56 Pulsewidth: 28 HZ: 5	Energy: 52 Pulsewidth: 26 HZ: 5

755/808/1064 Diode laser treatment parameters (10HZ)

MAN	I	II	III	IV	V	VI
Whiskers	Energy: 104 Pulsewidth: 26 HZ: 10	Energy: 104 Pulsewidth: 26 HZ: 10	Energy: 100 Pulsewidth: 25 HZ: 10	Energy: 96 Pulsewidth: 24 HZ: 10	Energy: 96 Pulsewidth: 24 HZ: 10	Energy: 84 Pulsewidth: 21 HZ: 10
Armpit	Energy: 104 Pulsewidth: 26 HZ: 10	Energy: 104 Pulsewidth: 26 HZ: 10	Energy: 100 Pulsewidth: 25 HZ: 10	Energy: 100 Pulsewidth: 25 HZ: 10	Energy: 100 Pulsewidth: 25 HZ: 10	Energy: 96 Pulsewidth: 24 HZ: 10
Hairline	Energy: 100 Pulsewidth: 25 HZ: 10	Energy: 100 Pulsewidth: 25 HZ: 10	Energy: 100 Pulsewidth: 25 HZ: 10	Energy: 96 Pulsewidth: 24 HZ: 10	Energy: 96 Pulsewidth: 24 HZ: 10	Energy: 92 Pulsewidth: 23 HZ: 10
Bikini	Energy: 100 Pulsewidth: 25 HZ: 10	Energy: 100 Pulsewidth: 25 HZ: 10	Energy: 100 Pulsewidth: 25 HZ: 10	Energy: 100 Pulsewidth: 25 HZ: 10	Energy: 100 Pulsewidth: 25 HZ: 10	Energy: 92 Pulsewidth: 23 HZ: 10
Thigh	Energy: 104 Pulsewidth: 26 HZ: 10	Energy: 104 Pulsewidth: 26 HZ: 10	Energy: 100 Pulsewidth: 25 HZ: 10	Energy: 100 Pulsewidth: 25 HZ: 10	Energy: 100 Pulsewidth: 25 HZ: 10	Energy: 92 Pulsewidth: 23 HZ: 10
Leg	Energy: 104 Pulsewidth: 26 HZ: 10	Energy: 104 Pulsewidth: 26 HZ: 10	Energy: 104 Pulsewidth: 26 HZ: 10	Energy: 100 Pulsewidth: 25 HZ: 10	Energy: 100 Pulsewidth: 25 HZ: 10	Energy: 92 Pulsewidth: 23 HZ: 10

FEMALE	I	II	III	IV	V	IV
Face	Energy: 108 Pulsewidth: 27 HZ: 10	Energy: 100 Pulsewidth: 25 HZ: 10	Energy: 100 Pulsewidth: 25 HZ: 10	Energy: 96 Pulsewidth: 24 HZ: 10	Energy: 96 Pulsewidth: 24 HZ: 10	Energy: 92 Pulsewidth: 23 HZ: 10
Armpit	Energy: 108 Pulsewidth: 27 HZ: 10	Energy: 100 Pulsewidth: 25 HZ: 10	Energy: 100 Pulsewidth: 25 HZ: 10	Energy: 96 Pulsewidth: 24 HZ: 10	Energy: 96 Pulsewidth: 24 HZ: 10	Energy: 92 Pulsewidth: 23 HZ: 10
Hairline	Energy: 104 Pulsewidth: 26 HZ: 10	Energy: 100 Pulsewidth: 25 HZ: 10	Energy: 96 Pulsewidth: 24 HZ: 10	Energy: 92 Pulsewidth: 23 HZ: 10	Energy: 92 Pulsewidth: 23 HZ: 10	Energy: 84 Pulsewidth: 21 HZ: 10
Bikini	Energy: 104 Pulsewidth: 26 HZ: 10	Energy: 100 Pulsewidth: 25 HZ: 10	Energy: 96 Pulsewidth: 24 HZ: 10	Energy: 92 Pulsewidth: 23 HZ: 10	Energy: 92 Pulsewidth: 23 HZ: 10	Energy: 88 Pulsewidth: 22 HZ: 10
Thigh	Energy: 108 Pulsewidth: 27 HZ: 10	Energy: 104 Pulsewidth: 26 HZ: 10	Energy: 100 Pulsewidth: 25 HZ: 10	Energy: 96 Pulsewidth: 24 HZ: 10	Energy: 96 Pulsewidth: 24 HZ: 10	Energy: 92 Pulsewidth: 23 HZ: 10
Leg	Energy: 108 Pulsewidth: 27 HZ: 10	Energy: 100 Pulsewidth: 25 HZ: 10	Energy: 100 Pulsewidth: 25 HZ: 10	Energy: 92 Pulsewidth: 23 HZ: 10	Energy: 92 Pulsewidth: 23 HZ: 10	Energy: 88 Pulsewidth: 22 HZ: 10

Treatment methods

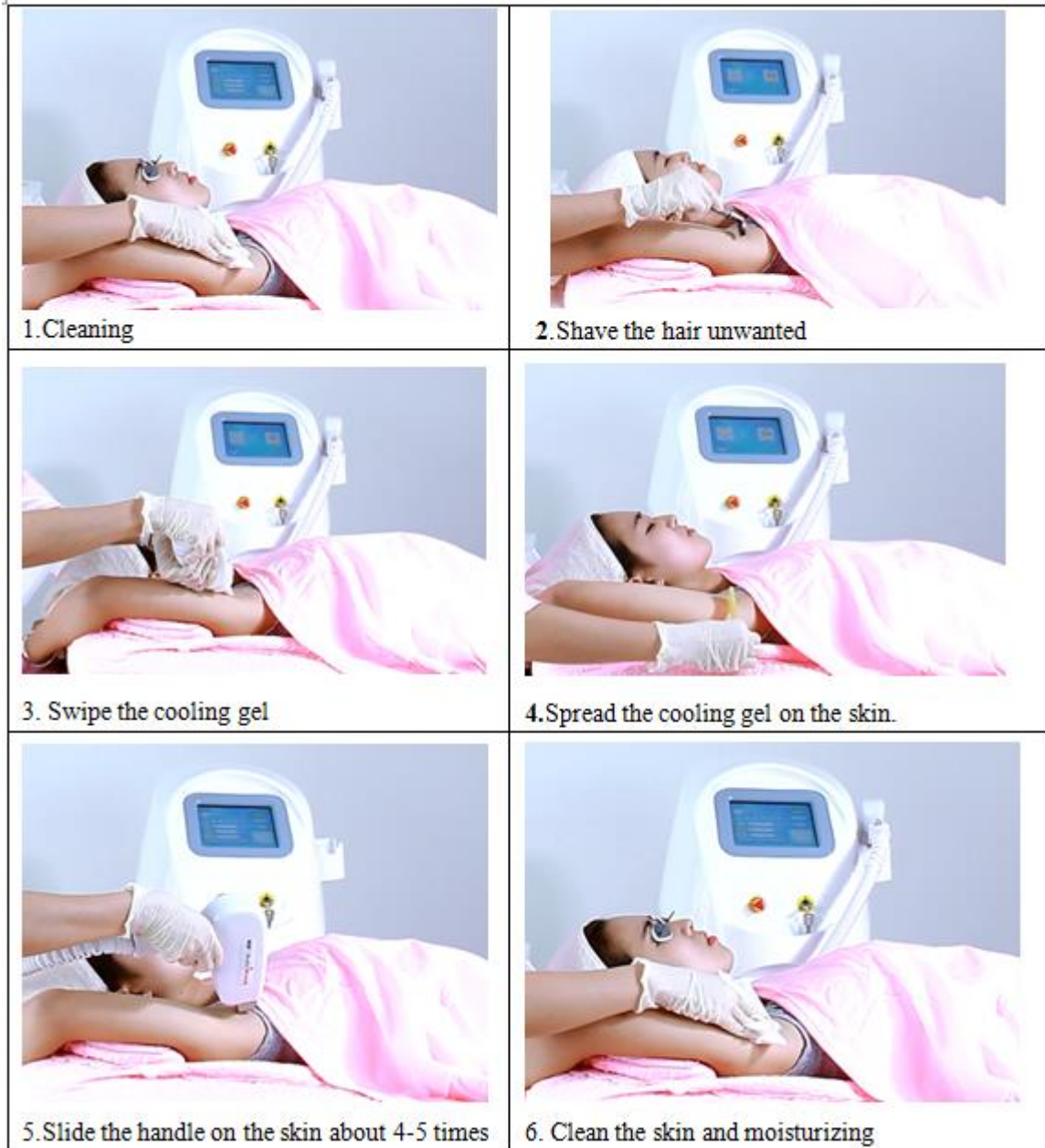

Post-Treatment Instructions

1. You may have a mild sunburn sensation following treatment, this is usually gone within a few hours. Skin redness, mild bruising and/or slight edema (swelling) are normal and may last a few days. You may

Take over-the-counter anti-inflammatory medication (such as ibuprofen) as desired. Avoid sun exposure. If sun exposure is unavoidable, you should use sunblock (SPF 30 or greater) for 4 to 6 weeks following your treatment.

2. Keep the treated area clean and dry for the next several days, gently wash twice daily. The pores will be open and you should not apply heavy creams or lotions as these may plug the pores and cause

Complications.

3. An over-the-counter ointment healing may also be used if blisters develop. Ice packs or cool compresses are especially useful for the first few days. Avoid heat and do not use warm compresses. The treatment area may be left open and uncovered with no bandage or special dressing needed. Loose and comfortable clothing is recommended.

4. Do not scrub or exfoliate the treatment area for 7 days. Do not use chemicals or medications (other than those referred to in these Instructions) on the treated area for one week.

Please remember to clean hand piece after treatment.

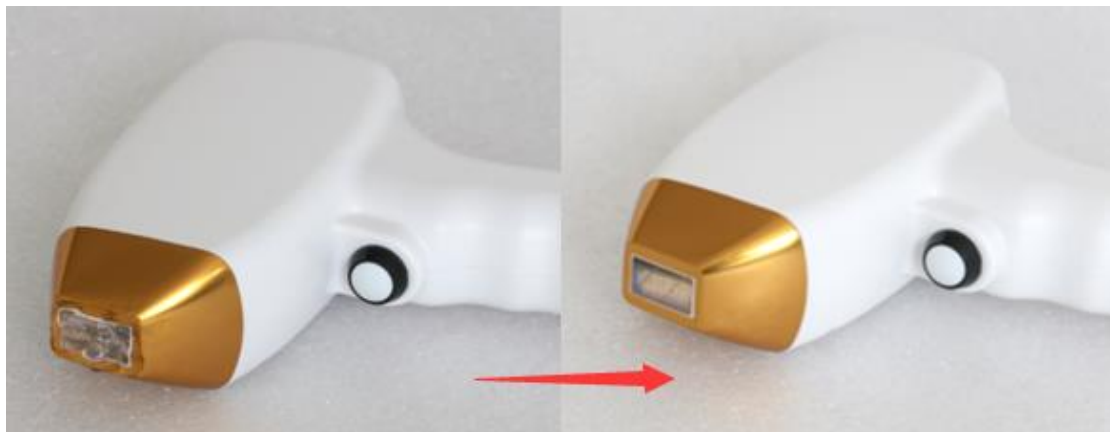

Chapter Six Simple Maintenance and Repair

I. Normal problems and failures

SYMPTOMS	POSSIBLE CAUSES	ACTIONS
After the main power is on, the indication on the screen does not light	The supply voltage is short	Check the required supply voltage is 230V AC or not
	The power plug has not been properly plugged	Tighten the plug
	The emergency switch is pressed	Turn the red emergency button clockwise release Emergency button
There is no light output, but the system seems running normally	Working button on hand piece is not pressed or broken	Change button
	Power board problem	Repair power board for change it
	Adjust the energy to zero	Adjust the energy to suitable parameter
Screen show "No water"	Screen flash "No water" and make Alarm sound	Check hand piece connection plug water tube is folded or not

II. Daily maintenance and repair

1. Change the Distilled Water or Pure water every two or three weeks
2. Change the Water Filter every month
3. Sweep this machine surface once a week with the soft wet cloth. Neutral detergents can be used but be careful and do not let the liquid infiltrate into the machine.
4. The light lead crystal should be clean at any times. It should be wiped each time after treatment. When wiping the light lead crystal, wipe with the wet soft cloth first time, use another piece of soft cloth with absolute alcohol to clean, then dry in the air.
5. Each Diode laser treatment head has a specific service life. Please contact the dealer when replacing a new treatment head at the appointed time.
6. This section enumerates some malfunction phenomenon and solutions.

Malfunction phenomenon	Solutions
Has no display	Check power cable
	Check the urgent switch, press bottom and loosen it clockwise.
	Check the air switch, if it jumps down, push it up. If it jumps down again, please contact the manufacture
While touching the key, the system has no reaction	Please contact the manufacture
The system won't start	Key switch is not turned to the appropriate position, turn it clockwise.
System can't initialize	Please contact the manufacture
Malfunction of diode laser treat head	The Laser transmitter has reached to its end of life, please change the diode laser treat head or Laser transmitter
	The diode laser head is probably damaged, please change diode laser head or contact the manufacture
The diode laser head is leaking	The diode laser head is probably damaged, please change the diode laser treatment head or contact the manufacture
The cooling system temperature is high	Close the system, lower the temperature, Re- start Contact the dealer.
The power of The laser treatment head to weaken	The life of the diode laser treatment head is not long.

How to replace the water filter?

Uninstallation step:



1. Take down the filters as the arrow mark indicates.
2. Take down the blue small clip.
3. Press down the inner button as the arrow mark indicates.
4. Unplug the filters as the arrow mark indicates.

Installation step:



1. Plug the filter into the PE pipe following the arrow direction
2. Plug the blue clip into the slot of inner layer pipe following the arrow direction
3. Adjust the place of blue clip, making it inserted in the end
4. Push the filters into clamps following the arrow direction

Filter Installation Notice:

1. Please unplug the power cord and draw off the water before change the filter.
2. When connect the filter, the filter need insert in the end, to ensure can't be pulled out. Install the blue clip. If want to take out the filter, need to keep pressing down the inner button of the connector, then take out the filter.
3. If you want to change the filter, need to do strictly according to the arrow direction on the filter. Prohibit exchange the position and direction of the 2 filters.
4. After start the machine, check if there is any leaking carefully, if no leaking, then check again after 1-2 hours, to make sure everything is okay.

III. Warranty

1. All products are strictly tested before sale. We can guarantee one-year free repair from the date of purchasing. During the guarantee period, we will repair the machine for free if the malfunction is caused by the quality of our product.

2. The standard of operation and environment should comply with the product Specification.

3. Malfunctions caused by the following reasons are out of the scope of our guarantee:

a. Malfunctions caused by abused operation

b. Malfunctions caused by other artificial factors like move or tear down in proper motion, or collision, etc.

c. Energy reduce caused by wet environment and dust

d. Malfunction caused by uncontrollable natural force e. Spare parts and accessories of this machine